



Office Furniture

Modular Workstation, Desking, Seating,
Storage, Social Office and more

Index

Desking

Premium Suites

Page 17 - 33



Executive Suites

Page 34 - 46



Office Desks

Page 47 - 57



Index

Desking

Conference Table

Page 58 – 69



Reception Table

Page 70 – 71



Training Table

Page 72



Cafeteria and Breakout Tables

Page 73 – 77



Seating

Leather and Leatherette Chairs

Page 79 – 87



Mesh Back Chairs

Page 88 – 92



Cushion Back Chairs

Page 93 – 107



Training Room Chairs

Page 108 – 110



Index

Seating

Multipurpose

Page 111 – 117



Cafeteria and Breakout Chairs

Page 118 – 119



Public Seating

Page 120 – 124



Auditorium Seating

Page 125 – 129



Lounge Seating

Page 130 – 133



Active Seating Solution

Page 134 – 137



Cue

Page 138 – 142

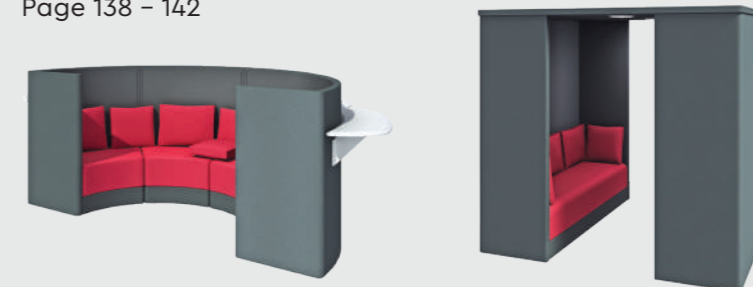

Index

Modular Workstations

Introduction

Page 145 – 147



Mobile Systems

Page 148 – 149



Panel-based Systems

Page 150 – 153



Desk-based Systems

Page 154 – 158



Storage

Aisle and Back Storage

Page 160 – 173

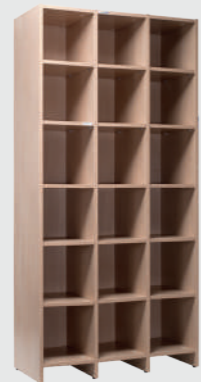

Modular Storage

Page 169



Display Storage

Page 174 – 177



Index

Storage

Modular Display

Page 176



Personal Storage

Page 178 – 182



Conventional Storage

Page 183 – 185

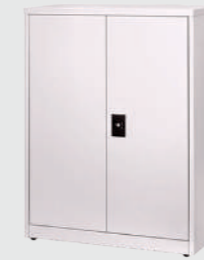

High Density Storage

Page 186 – 193



Social Office

Immerse Work Pod

Page 195



Assert Range

Page 196



Index

Social Office

Topo Range
Page 197



Tetris Range
Page 198



ORBB Range
Page 199



Graph Range
Page 200



Omega Range
Page 201



Personal Workstations
Page 202 – 203



Lamps
Page 204



Neo Bookshelf
Page 205



Index

Lounge

Sofas
Page 207

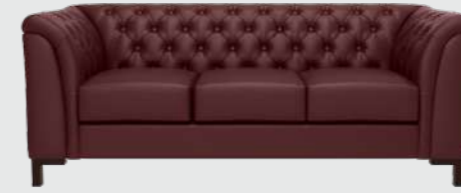

Centre Tables
Page 213



Executive Dining
Page 216



Colour, Finishes and Textures

Colour, Finishes and Textures
Page 219 – 229

Other Segments

Healthcare & Laboratory Furniture
Page 230 – 231





Partnering India In Building A Better Tomorrow.

We are India's largest home & institutional furniture manufacturer since 1936. With a focus on Make in India products, manufactured in state-of-the-art facilities meeting global design, quality and test standards.

Supporting modern nation-building with products, services and initiatives geared towards a greener, healthier, progressive and prosperous future.



125 Years Of Legacy. 1000+ Projects Delivered Annually.

With a rich legacy that spans over 125 years, Godrej is a pioneer across industries in India.

Led by India's largest in-house furniture design team, our aim is to transform spaces with thoughtfully-designed furniture. And our goal is to create brighter homes and offices with products that have the highest design quotient in aesthetics, functionality, and technology.

Godrej Interio at a glance

- India's largest home & institutional furniture manufacturer, since 1936; supporting nation building.
- 95% ex-works TOC performance through project tools and dedicated team to ensure on-time project delivery
- Unique customization capabilities
- Winner of 34 India Design Mark Awards till date.

Widest product portfolio across product lines

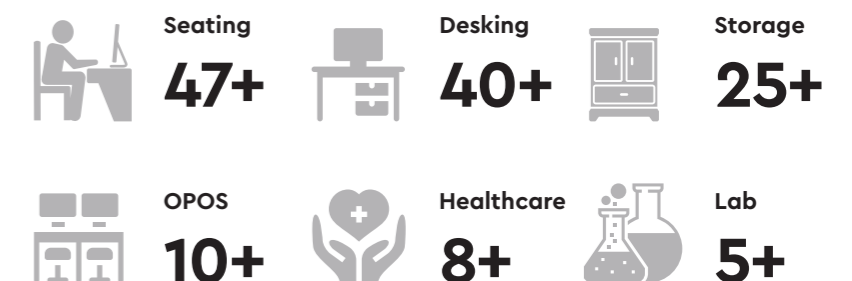



- **900+**
Network of B2B dealers and service partners
- **4** B2B Display Centres
Pune • Bengaluru • Delhi • Chennai
- **6** Experience Centres
Delhi • Mumbai (2) • Kolkata • Hyderabad • Chandigarh
- **1** Knowledge Centre
Mumbai

Our All India Presence

Get complete access to our wide range of workplace solutions across our 900+ dealers and partners in India. Manufactured at our facilities in Vikhroli, Shirwal, Khalapur, Haridwar, and Bhagwanpur, all our workplace products pass through multiple stringent quality checks before they reach you.

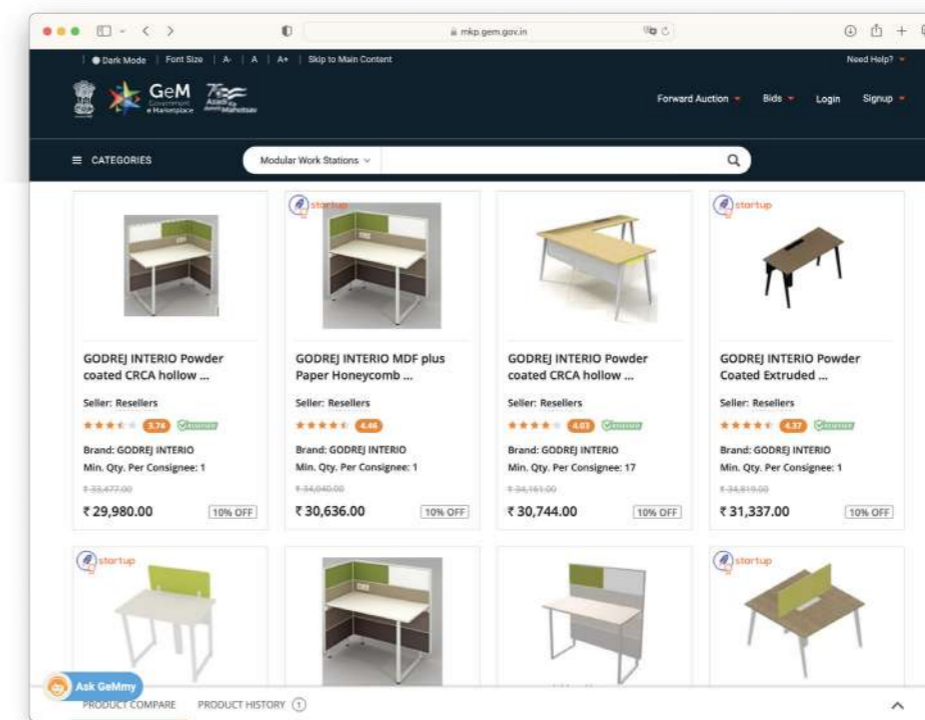

Rating of 4+ on GeM. Compliant & Widely Available.

Godrej Interio is the largest umbrella brand listed on the GeM portal: in 80+ categories under furniture and 190+ categories under office space. Interio has an overall rating of 4+ based on various parameters such as Delivery, Quality, Reliability and Feedback by buyers.

- Among **Top 15**
Sellers Registered On GeM
- **60,000+**
Product Listings
- **365+**
Re-seller Network
- **100+**
GeM Categories
- Products Listed In This Dossier Are Available On GeM Portal
- Additional Products Can Be Made Available As Per Requirement

Enforcing Green At Every Step

At Godrej Interio, our sustainability goals are ambitious. We do not just talk, we walk the talk.

We take our work seriously because we know our products and services touch people, transform lives and change the world.

When we add the element of sustainability and green living into what we do, it adds the positivity of hope to the promise of a better future, not only for people but for the planet as a whole.

Godrej interio
talk green.
walk green.



Materials

- Design For Environment
- Green Materials
- LCA



Transportation

- Green Modes Of Transportation



Manufacturing

- Energy Efficiency
- Zero Waste Water Discharge
- Renewal Energy
- Zero Waste Landfill



In Use

- Low Emitting Products
- Green Certification
- AMC



Packaging

- Flat Packaging
- Right Packaging



End Of Life

- Recycling Program
- Safe Disposal

India's First Net Zero Energy Building.

- CII certified state of the art manufacturing facilities across 6 locations
- Designed for the environment: Cradle to grave journey monitored



Greeneco certifications awarded to Vikhroli and Shirwal Units

Largest Portfolio of Certified Products



128+
Green Pro



59+
Green Guard



37+
GRIHA



18+
BIFMA Level 2



18+
SCS Indoor Advantage Gold

Towards Healthier Workspaces

Godrej interio
wellness@work

- Team of certified doctors / ergonomists to assist employee health and productivity challenges at workplace

- Ergonomics Program helps organizations improve employee comfort, lowers injuries arising out of sedentary lifestyle at work

- Initiatives help reduce healthcare cost

- Team is backed by research and advisory experience spanning across corporate, government and healthcare organizations.



Awards & Recognitions

F70 AWARDS

**Franchise India
Retail Brand
of the Year**
Speciality/Furniture
Retail Category
December 2022



**India's
Most Trusted Brand**
TRA Research
Furniture Category
February 2022



**India's
Most Desired Brand**
TRA Research
Furniture Category
July 2021



**GreenCo Star
Performer Award**

Godrej Interio Shirwal
Plant received award
at CII GreenCo
Summit 2019.



**National Energy
Leader Award**

Godrej Interio Shirwal
Plant received award
at CII National Award
for Excellence in Energy
Management 2018.



**CII Best Environmental
Practices - Innovative
Project Award**

Godrej Interio received
award at CII GreenCo
Summit 2018.



India Design Mark

A recipient of 34 India
Design Mark Awards,
and counting.



Super Brand Award

Godrej Interio
received award at the
SuperBrands event
held in Delhi.



CII-Exim Bank Award

Godrej Interio received
award for Business
Excellence in 2017.

Desking

Page 17

Premium Suites

Page 47

Office Desks

Page 70

Reception Table

Page 73

**Cafeteria and
Breakout Tables**

Page 34

Executive Suites

Page 58

**Conference
Table**

Page 72

Training Table

Coeval



Design Registered

Features

- The Coeval Desk is made using high gloss PU-finish panels, with toughened streak glass modesty for the main desk.
- It's available in multiple options in return units for varied user preferences.
- Comes equipped with a push-to-open mechanism for all drawers.
- Multiple storage options are provided in the form of back units, storage units, and pedestal.
- The Coeval Desk features in-built lights that can be adjusted as per your requirement.

Colour & Material

PU RANGE

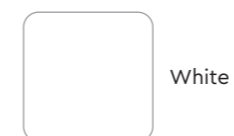

In the set above

Coeval Premium Suite

Main Desk

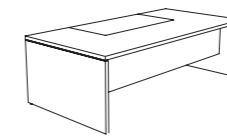

Return Unit 700D



Flap Up Unit



Display Unit



Pair with

Return Unit 550D



Independent Low Height Return Unit



Medium Height Back Unit

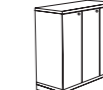
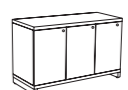

Table Height Back Unit



Pedestal



Wardrobe Unit



Marvel High Back Chair

→ Pg 79



Coeval Premium Suite

Colour & Material

PU RANGE



Measurements

Main Desk Option 2

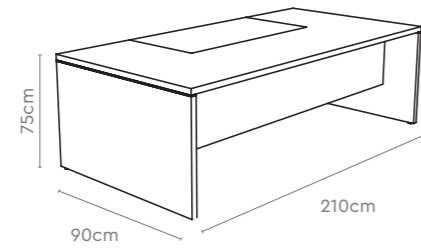

Return Units LH & RH

Return Unit 700D

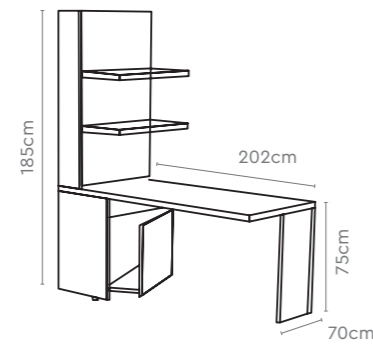

Return Unit 550D

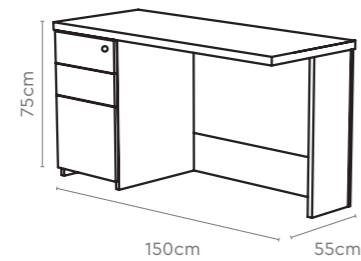

Independent Low Height Return Unit

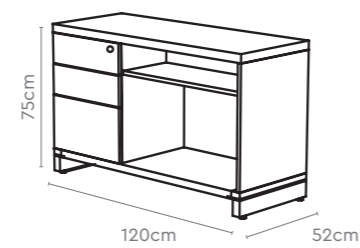

All sizes in cm	Width	Depth	Height
Main Desk Option 1	240.0	105.0	75.0
Main Desk Option 2	210.0	90.0	75.0
Independent Low Height Return Unit	120.0	52.0	75.0
Return Unit 550D	150.0	55.0	75.0
Return Unit 700D	202.0	70.0	185.0

Coeval Premium Suite

Colour & Material

PU RANGE

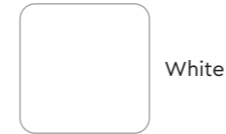

Measurements

Medium Height Back Unit

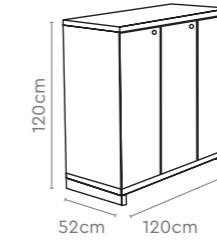
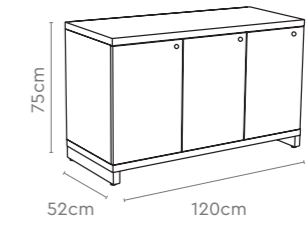
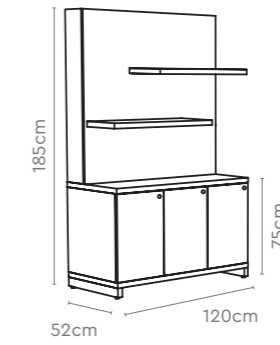

Table Height Back Unit



Display Unit



Flap-Up Unit

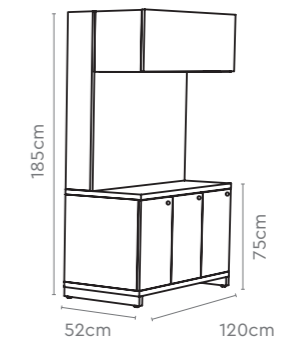

Wardrobe Unit

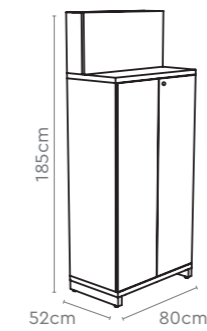

Pedestal

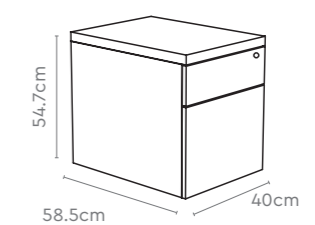

All sizes in cm	Width	Depth	Height
Medium Height Back Unit	120.0	52.0	120.0
Table Height Back Unit	120.0	52.0	75.0
Display Unit	120.0	52.0	185.0
Flap-Up Unit	120.0	52.0	185.0
Pedestal	40.0	58.5	54.7
Wardrobe Unit	80.0	55.0	75.0

Aristo



Design Registered

Features

- The Aristo comes complete with softened corners and chamfered edges that offer user comfort and convenience.
- Its simple horizontal line pattern and dark wood grains make for an elegant finish.
- The soft-close sliding doors, with aluminium handles for back units, ensure ease of operation.

In the set

Aristo Premium Suite

Main Table + Eru
(with or without Pedestal)

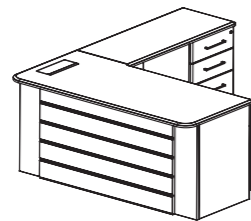

Back Unit 1

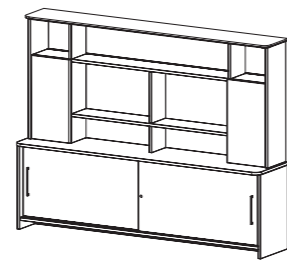

Pair with

Back Unit 1

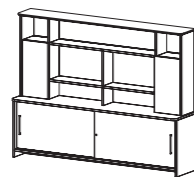

Back Unit 2

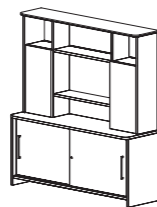

Back Unit 4

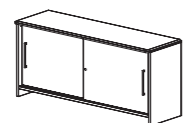

Marvel High Back Chair



→ Pg 79



Colour & Material

MEMBRANE & LAMINATE



Tobacco Ash & Black

Aristo Premium Suite

Colour & Material

MEMBRANE & LAMINATE

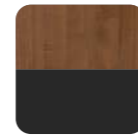

Tobacco Ash & Black

Measurements

Main Table + Eru
(with or without Pedestal)

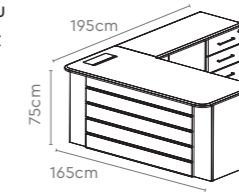

Back Units

Back Unit 1

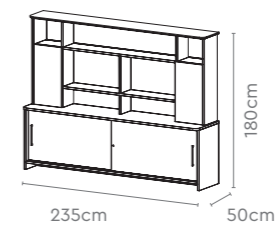

Back Unit 2

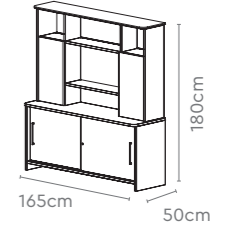

Back Unit 3

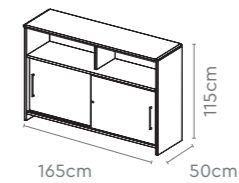

Back Unit 4

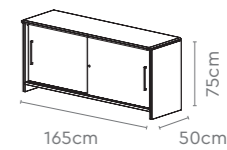

All sizes in cm

	Width	Depth	Height
Main Table + Eru with Pedestal	165.0	195.0	75.0
	180.0	210.0	75.0
	210.0	225.0	75.0
	235.0	235.0	75.0
Main Table + Eru (W/o Eru Pedestal)	165.0	165.0	75.0
Back Unit 1	235.0	50.0	180.0
Back Unit 2	165.0	50.0	180.0
	180.0	50.0	180.0
Back Unit 3	165.0	50.0	115.0
	180.0	50.0	115.0
	235.0	50.0	115.0
Back Unit 4	165.0	50.0	75.0
	180.0	50.0	75.0
	235.0	50.0	75.0

Topaz



Design Registered

Features

- The clean lines on the Topaz desk surface blend well with its raw wood grain and aesthetic door handles.
- Geometric lines run throughout the panel, making optimum use of lighter shades to present a uniform and neat look.
- The unique pattern on the fascia and the modesty panel, ups the style quotient of any space the Topaz sits in.

Colour & Material

MEMBRANE & LAMINATE

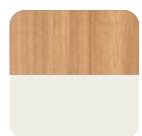

Tiepolo PC & Frosty White

In the set above

Topaz Premium Suite



Main Table + Eru
(with or without Pedestal)

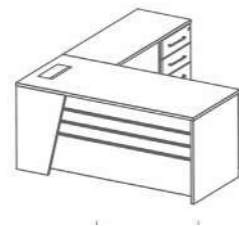

Back Unit 3

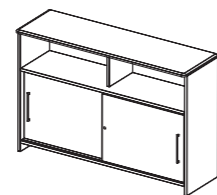

Pair with

Back Unit 1

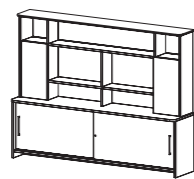

Back Unit 2

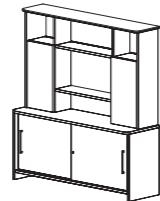

Back Unit 4

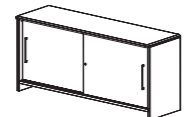

Greta High Back Chair



→ Pg 88

Topaz Premium Suite

Colour & Material

MEMBRANE & LAMINATE

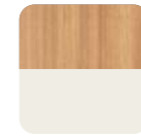

Tiepolo PC & Frosty White

Measurements

Main Table + Eru
(with or without Pedestal)

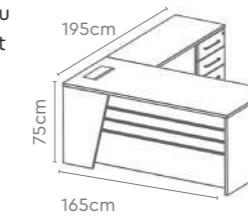

Back Unit 1

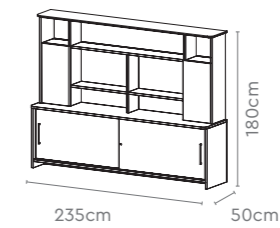

Back Unit 2

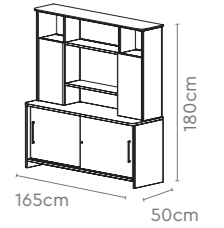

Back Unit 3

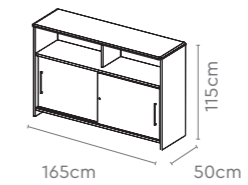

Back Unit 4

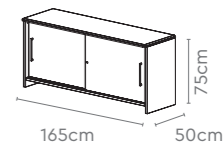

All sizes in cm

	Width	Depth	Height
Main Table + Eru with Pedestal	165.0	195.0	75.0
	180.0	210.0	75.0
	210.0	225.0	75.0
	235.0	235.0	75.0
Main Table + Eru (W/o Eru Pedestal)	165.0	165.0	75.0
Back Unit 1	235.0	50.0	180.0
Back Unit 2	165.0	50.0	180.0
	180.0	50.0	180.0
Back Unit 3	165.0	50.0	115.0
	180.0	50.0	115.0
	235.0	50.0	115.0
Back Unit 4	165.0	50.0	75.0
	180.0	50.0	75.0
	235.0	50.0	75.0

Cignus



Design Registered

Features

- The swan-like flowing design of the Cignus desk is aesthetically highlighted with its contrasting colour scheme.
- All of its back units blend seamlessly with the main table, creating a rich and aesthetic office space.
- The flowing lines on the Cignus continue on its modesty, with a slanted cut to the panel that perfectly complements the return unit.

Colour & Material

MEMBRANE & LAMINATE



Noce Versailles & Frosty White

In the set above

Cignus Premium Suite

Main Table + Eru
(with or without Pedestal)

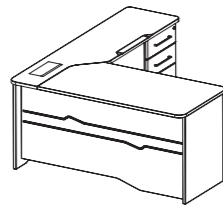

Back Unit 1

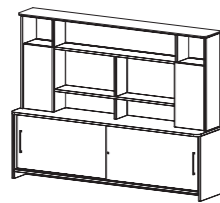

Back Unit 2

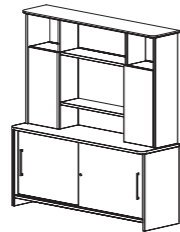

Pair with

Back Unit 3

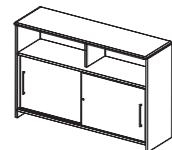

Back Unit 4

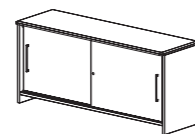

Marvel High Back Chair

→ Pg 79



Cignus Premium Suite

Colour & Material

MEMBRANE & LAMINATE



Noce Versailles & Frosty White

Measurements

Main Table + Eru
(with or without Pedestal)

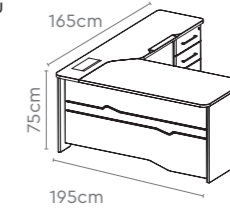

Back Unit 1

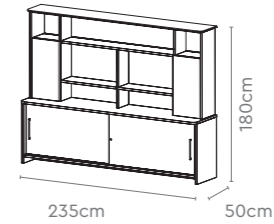

Back Unit 2

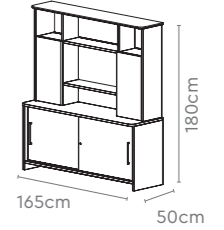

Back Unit 3

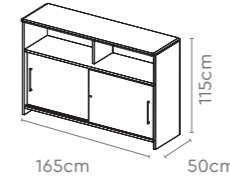

Back Unit 4

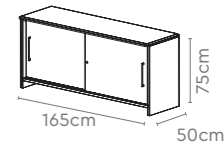

All sizes in cm

	Width	Depth	Height
Main Table + Eru with Pedestal	165.0	195.0	75.0
	180.0	210.0	75.0
	210.0	225.0	75.0
	235.0	235.0	75.0
Main Table + Eru (W/o Eru Pedestal)	165.0	165.0	75.0
Back Unit 1	235.0	50.0	180.0
Back Unit 2	165.0	50.0	180.0
	180.0	50.0	180.0
Back Unit 3	165.0	50.0	115.0
	180.0	50.0	115.0
	235.0	50.0	115.0
Back Unit 4	165.0	50.0	75.0
	180.0	50.0	75.0
	235.0	50.0	75.0

Arrive



Features

- You know you have arrived in life when an all-Veneer desk sits in your office space.
- This symbol of status and luxury comes with a soft Italian black leather that sits atop a sturdy square table-board. Speak about tempering force with grace.
- Its sleek design comes with a smart case-space that effortlessly slides in. Perfect for storing all your files and papers, and keeps your desk clutter-free.

In the set

Arrive Premium Suite

Main Desk

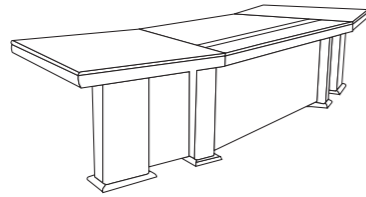

Mobile Cabinet

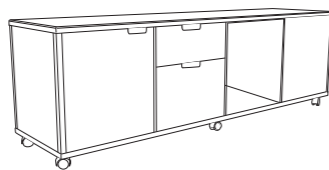

Pair with

Mobile Pedestal



Back Unit

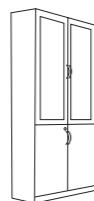

Pulse High Back Chair

→ Pg 89



Colour & Material

VENEER



Walnut

Arrive Premium Suite

Colour & Material

VENEER



Walnut

Measurements

Main Desk

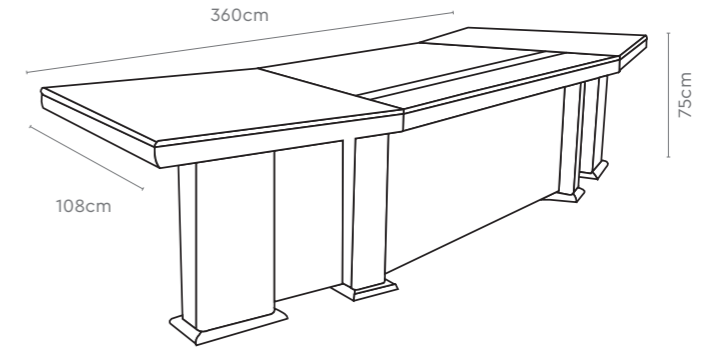

Mobile Cabinet

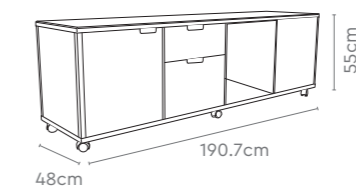

Pedestal

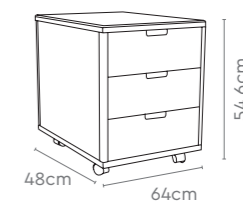

Back Unit

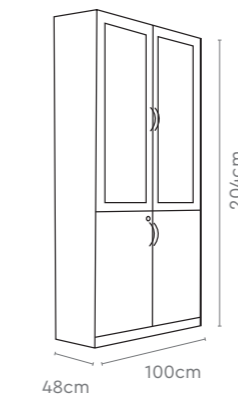

All sizes in cm

	Width	Depth	Height
Main Desk	360.0	108.0	75.0
Mobile Cabinet	190.7	48.0	55.0
Pedestal	48.0	64.0	54.6
Back Unit	100.0	48.0	204.0

Impress



Features

- The Impress desk comes with a Veneer finish that gives it a premium feel and aesthetic.
- The leather padding across its width reduces wear and tear, while ensuring complete comfort while working.
- Enjoy a clutter-free workspace, thanks to its efficient wire management provisions.
- The side unit can be placed on either side of the user, and comes with ample storage space.

Colour & Material

VENEER



Walnut

In the set

Impress Premium Suite

Executive Desk

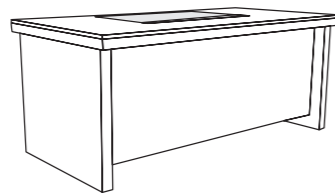

Pair with

Mobile Pedestal



Credenza



Mobile Side Unit

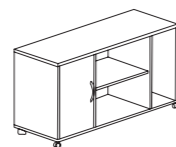

Pulse High Back Chair

→ Pg 89



Impress Premium Suite

Colour & Material

VENEER



Walnut

Measurements

Executive Desk

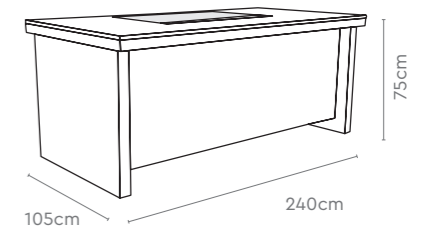
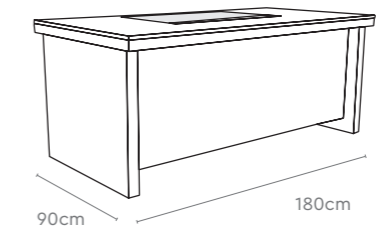

Mobile Side Unit

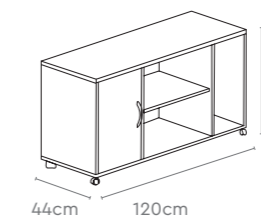

Mobile Pedestal

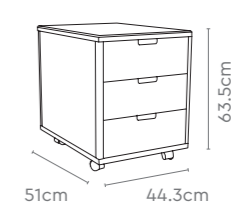

Credenza

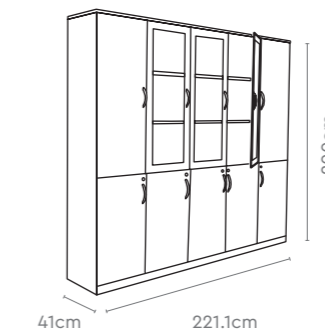

All sizes in cm

	Width	Depth	Height
Executive Desk	180.0	90.0	75.0
	240.0	105.0	75.0
Mobile Side Unit	120.0	44.0	65.0
Mobile Pedestal	44.3	51.0	63.5
Credenza	221.1	41.0	200.0

Jefferson Presidential Suite



Features

- The Jefferson Presidential Suite is earned its name at first sight.
- Crafted with natural Veneer, it's every bit as majestic as it can get.
- Its large curvilinear worktop facilitates quick team meetings and discussions, and is complete with a scratch and stain resistant polyester finish.
- Get the full presidential look with a matching side unit, credenza, and tower case.

Colour & Material

VENEER



Pamello

In the set

Jefferson Presidential Suite

Executive Desk

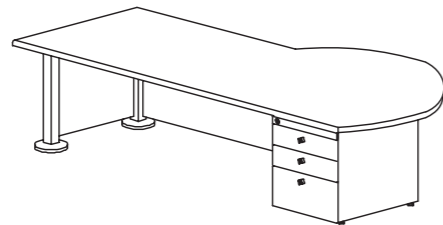

L.H.S  R.H.S 

Tower Case

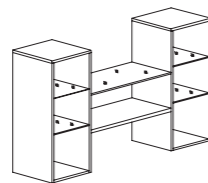

Side Unit

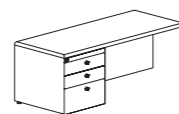

Pair with

Credenza

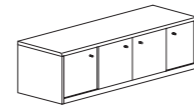

Greta High Back Chair

→ Pg 88



Jefferson Presidential Suite

Colour & Material

VENEER

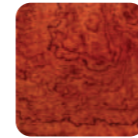

Pamello

Measurements

Executive Desk

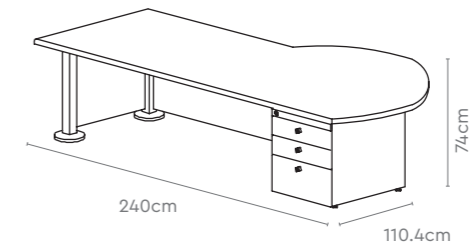

Side Unit

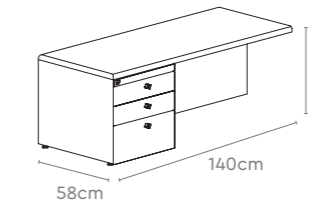

Credenza

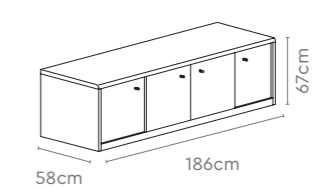

Tower Case

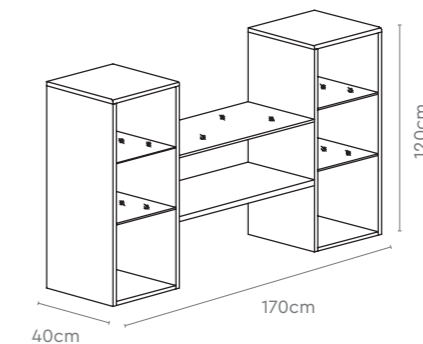

All sizes in cm

	Width	Depth	Height
Executive Desk	240.0	110.4	74.0
Side Unit	140.0	58.0	69.0
Credenza	186.0	58.0	67.0
Tower Case	170.0	40.0	120.0

Maestro



Features

- The Maestro's Duck Nose profile edge enhances your workplace's aesthetics.
- Comes with a side unit with a pedestal, and an extended table for extra storage.
- The pedestal stand with handles also adds to the overall style of your office space.
- Conduct impromptu meetings with ease, thanks to the joinery table.

Colour & Material

WOOD



Oxford Cherry with Black Joining Top

In the set

Maestro Premium Suite

Executive Desk

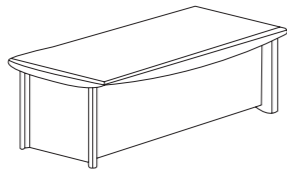

Side Unit



Joining Top

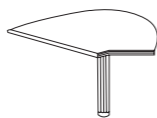

Bookcase Unit

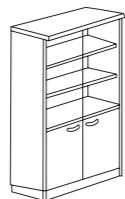

Credenza



Pair with

Mobile Pedestal

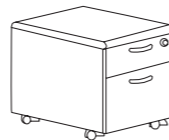

Maestro Premium Suite

Colour & Material

WOOD



Oxford Cherry with Black Joining Top

Measurements

Executive Desk

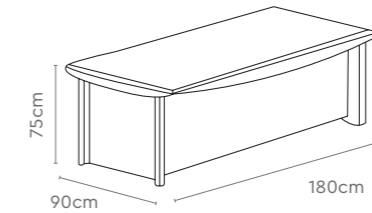

Mobile Pedestal

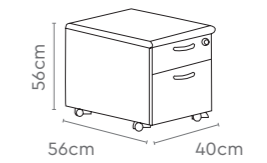

Side Unit

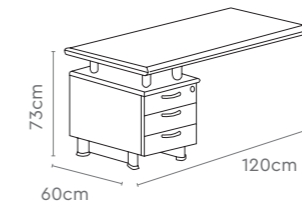

Joining Top

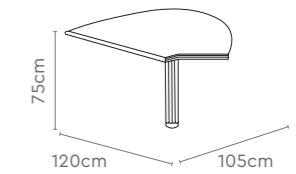

Bookcase Unit

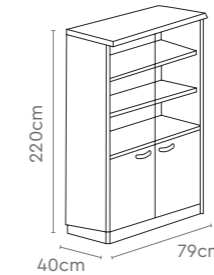

Credenza

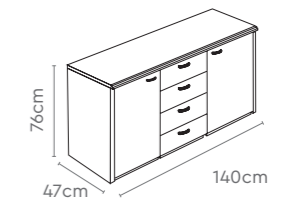

All sizes in cm

	Width	Depth	Height
Executive Desk	180.0	90.0	75.0
Side Unit	120.0	60.0	73.0
Joining Top	105.0	120.0	75.0
Bookcase Unit	79.0	40.0	220.0
Credenza	140.0	47.0	76.0
Mobile Pedestal	40.0	56.0	56.0

Aristo



Features

- The Aristo comes complete with softened corners and chamfered edges that offer user comfort and convenience.
- Its simple horizontal line pattern and dark wood grains make for an elegant finish.
- The soft-close sliding doors, with aluminium handles for back units, ensure ease of operation.

In the set

Aristo Executive Suite

Main Table

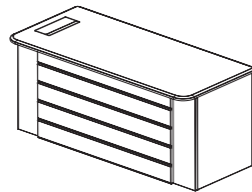

Back Unit 1

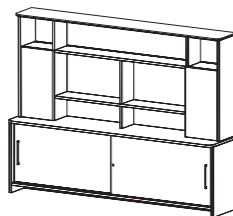

Back Unit 2

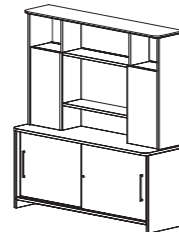

Pair with

Back Unit 3

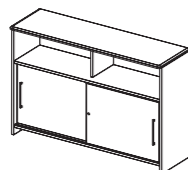

Back Unit 4

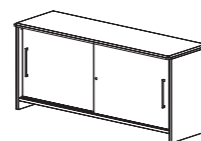

Colour & Material

MEMBRANE & LAMINATE



Tobacco Ash & Black



Design Registered

Aristo Executive Suite

Colour & Material

MEMBRANE & LAMINATE



Tobacco Ash & Black

Measurements

Main Table

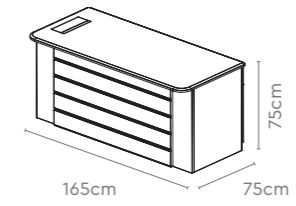

Back Unit 1

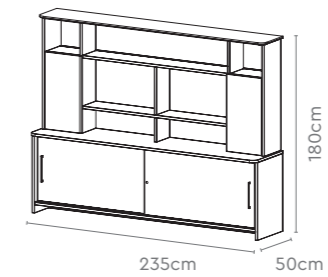

Back Unit 2

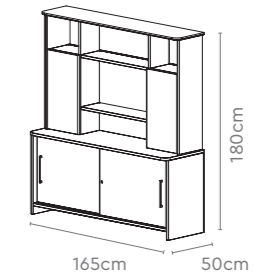

Back Unit 3

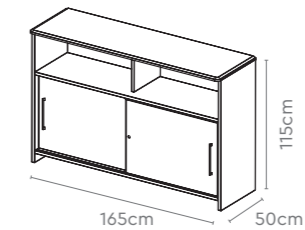

Back Unit 4

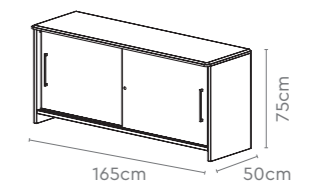

All sizes in cm

	Width	Depth	Height
Main Table	165.0	75.0	75.0
	180.0	90.0	75.0
Back Unit 1	235.0	50.0	180.0
Back Unit 2	165.0	50.0	180.0
	180.0	50.0	180.0
Back Unit 3	165.0	50.0	115.0
	180.0	50.0	115.0
Back Unit 4	235.0	50.0	115.0
	165.0	50.0	75.0
	180.0	50.0	75.0
	235.0	50.0	75.0

Topaz



Features

- The clean lines on the Topaz desk surface blend well with its raw wood grain and aesthetic door handles.
- Geometric lines run throughout the panel, making optimum use of lighter shades to present a uniform and neat look.
- The unique pattern on the fascia and the modesty panel, ups the style quotient of any space the Topaz sits in.

Colour & Material

MEMBRANE & LAMINATE

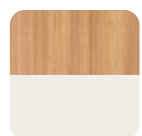

Tiepolo PC & Frosty White

In the set

Topaz Executive Suite

Main Table

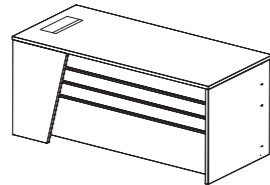

Back Unit 1

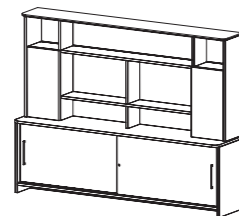

Back Unit 2

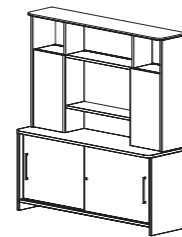

Pair with

Back Unit 3

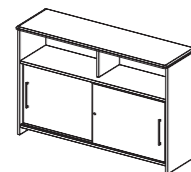

Back Unit 4

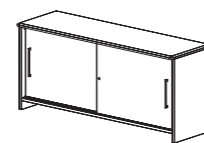

Design Registered

Topaz Executive Suite

Colour & Material

MEMBRANE & LAMINATE

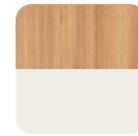

Tiepolo PC & Frosty White

Measurements

Main Table

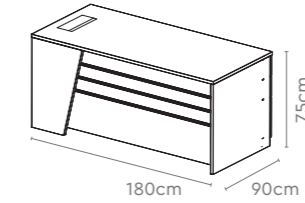

Back Unit 1

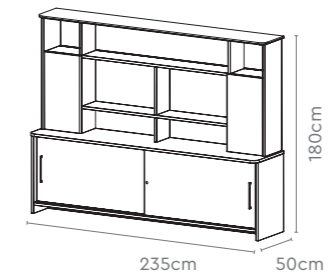

Back Unit 2

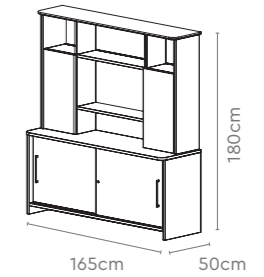

Back Unit 3

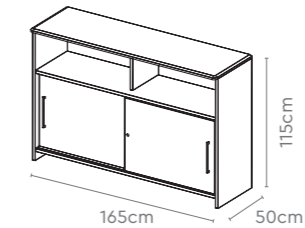

Back Unit 4

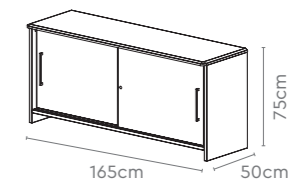

All sizes in cm

	Width	Depth	Height
Main Table	165.0	75.0	75.0
	180.0	90.0	75.0
Back Unit 1	235.0	50.0	180.0
Back Unit 2	165.0	50.0	180.0
	180.0	50.0	180.0
Back Unit 3	165.0	50.0	115.0
	180.0	50.0	115.0
Back Unit 4	235.0	50.0	115.0
	165.0	50.0	75.0
	180.0	50.0	75.0
	235.0	50.0	75.0

Cignus



Features

- The swan-like flowing design of the Cignus desk is aesthetically highlighted with its contrasting colour scheme.
- All of its back units blend seamlessly with the main table, creating a rich and aesthetic office space.
- The flowing lines on the Cignus continue on its modesty, with a slanted cut to the panel that perfectly complements the return unit.

In the set

Cignus Executive Suite

Main Table

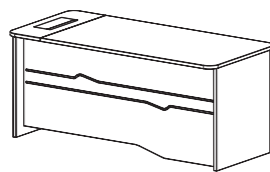

Back Unit 1

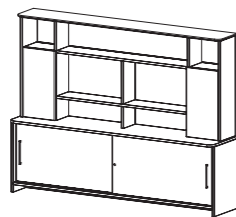

Back Unit 2

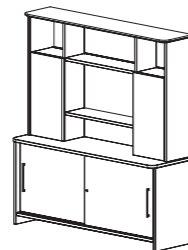

Pair with

Back Unit 3

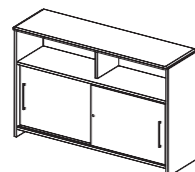

Back Unit 4

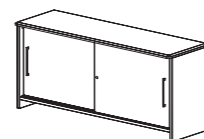

Colour & Material

MEMBRANE & LAMINATE



Noce Versailles & Frosty White



Design Registered

Cignus Executive Suite

Colour & Material

MEMBRANE & LAMINATE



Noce Versailles & Frosty White

Measurements

Main Table

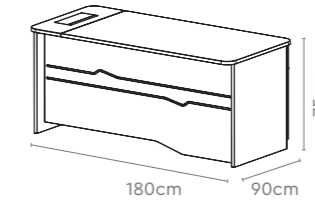

Back Unit 1

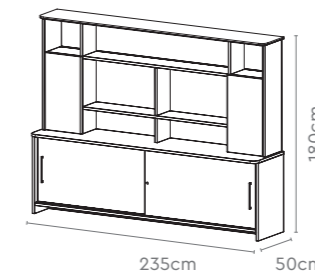

Back Unit 2

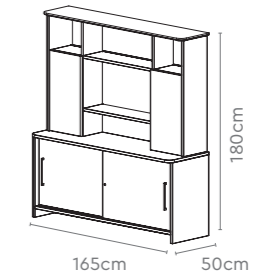

Back Unit 3

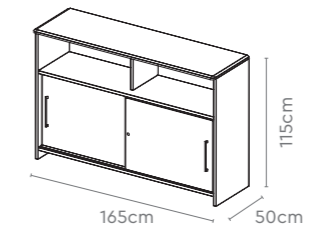

Back Unit 4

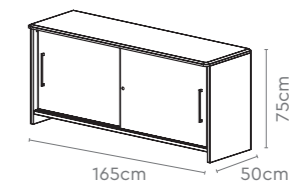

All sizes in cm

	Width	Depth	Height
Main Table	165.0	75.0	75.0
	180.0	90.0	75.0
Back Unit 1	235.0	50.0	180.0
Back Unit 2	165.0	50.0	180.0
	180.0	50.0	180.0
Back Unit 3	165.0	50.0	115.0
	180.0	50.0	115.0
	235.0	50.0	115.0
Back Unit 4	165.0	50.0	75.0
	180.0	50.0	75.0
	235.0	50.0	75.0

Trident Senior



Features

- The Trident Senior features a floating top with rounded edges that give it a comfortable finish.
- This two-piece workspace setup comprises of an executive desk and credenza with an open shelf space.
- The tops of the desk and the credenza are made from Medium Density Fiberboard (MDF), and covered with membrane foil to provide for a scratch and stain resistant work surface.

Measurements

Executive Desk

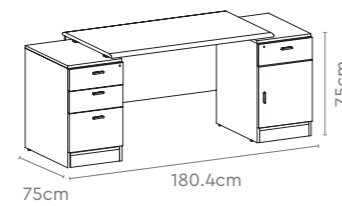

Credenza

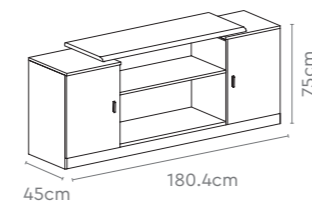

Colour & Material

MEMBRANE & LAMINATE



Palau Teak & Nova Magnolia & Kitami Elm

All sizes in cm	Width	Depth	Height
Executive Desk	180.4	75.0	75.0
Credenza	180.4	45.0	75.0

Trident Middle



Features

- Complete with an executive desk and a side unit, the Trident Middle comes in a compact form factor.
- While it's best suited for offices with limited cabin space, this desk packs a spacious in-built shelf for storing documents and personal belongings.
- Side unit available with an in-built pull-out keyboard tray.
- Can be configured LHS or RHS to suit your cabin layout.

Measurements

Executive Desk

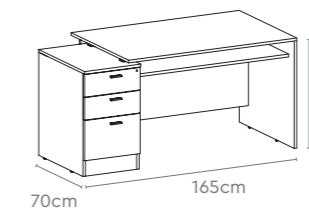

Side Unit

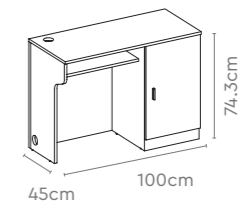

Colour & Material

MEMBRANE & LAMINATE



Palau Teak & Frosty White

All sizes in cm	Width	Depth	Height
Executive Desk	165.0	70.0	74.3
Credenza	100.0	45.0	74.3

Mayfair



Features

- The Mayfair is a versatile desk that enlivens the ambience of every cabin it's in.
- Its unique colour combination of White Cedar and Black gives it a clean look, that goes well with any office setting.
- The executive desk and side unit come equipped with grommets for wire management, and a clutter-free desktop.
- Comes in a variety of sizes for different cabin layouts, and the main desk can be complemented with a matching pedestal, side unit, and credenza.

Measurements

Executive Desk

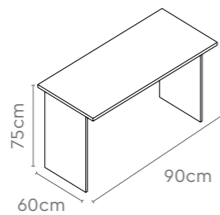

Side Unit

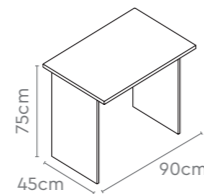

Mobile Pedestal

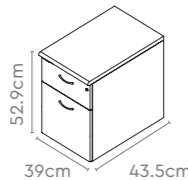

Credenza

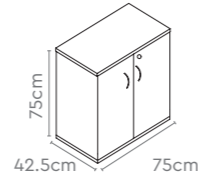

All sizes in cm	Width	Depth	Height
Executive Desk	90.0	60.0	75.0
	120.0	60.0	75.0
	135.0	75.0	75.0
Side Unit	90.0	45.0	75.0
	120.0	45.0	75.0
Mobile Pedestal	39.0	43.5	52.9
Credenza	75.0	42.5	75.0

Colour & Material

LAMINATE



Malaga Cherry & Cloud Grey

Ascent



Features

- The Ascent is an all-in-one desking solution.
- Its wide floating top makes it spacious enough to accommodate a monitor, work files, and personal decor.
- Comes with a raised-leg design for easy cleaning.
- Built-in utility trays, pull-out keyboard tray, storage and CPU-space helps you organise your workspace better.

Measurements

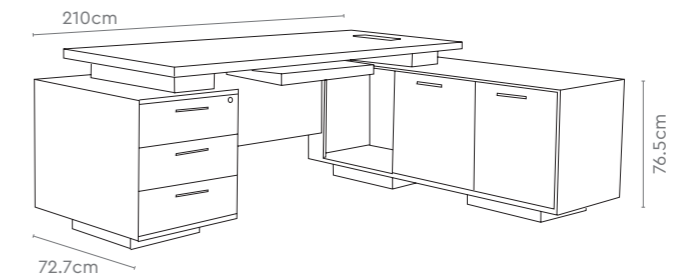

Colour & Material

WOOD

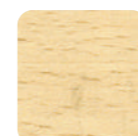

Maple

All sizes in cm	Width	Depth	Height
Overall	210.0	72.7	76.5
Executive Desk	180.0	79.5	76.5
Side Unit	160.0	50.0	65.0

Finesse



Features

- The Finesse desk offers options of LHS/RHS configuration to suit any cabin layout.
- Pair your executive desk with a matching side unit and credenza for a seamless workspace.
- Executive desk and side unit are available in different sizes to suit varying cabin sizes.
- Comes with cut-outs on the desktop for efficient and clutter-free wire management.

Measurements

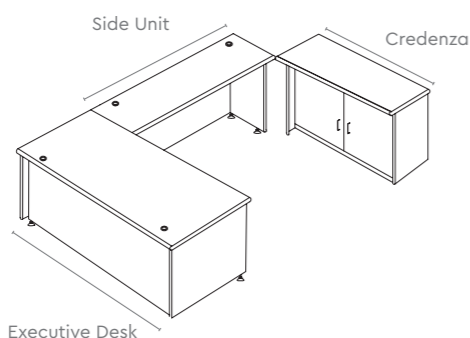

Pair with

Diva Model 7045

→ Pg106



Colour & Material

LAMINATE

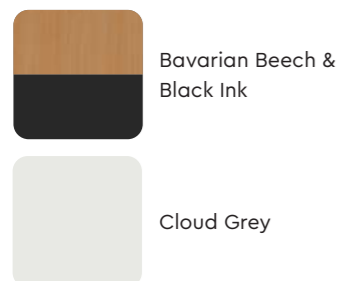

All sizes in cm	Width	Depth	Height
Executive Desk 4020	120.0	60.0	74.0
Executive Desk 5026	150.0	75.0	74.0
Executive Desk 5630	165.0	90.0	74.0
Executive Desk 6030	180.0	90.0	74.0
Side Unit 3619	105.0	45.0	70.5
Side Unit 5219	155.0	45.0	70.5
Credenza 4319	128.0	42.5	70.5

T-22 Unitized Table

Features

- The T-22 Unitized table has a clean and minimalistic aesthetic.
- Comes with a integrated switch box for power access, and a soft-closing access flap for easy cable management.
- Finished with a mobile wooden three drawer pedestal and a modesty panel at the visitor's end.
- Available in multiple sizes and module configurations.



Colour & Material

METAL POWDER COAT

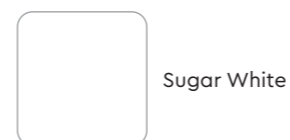

METAL EDGE BAND & POWDER COAT

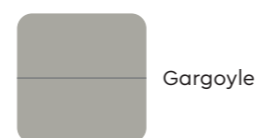

Measurements

T-22 Unitized Table

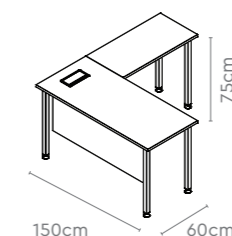

Wooden Pedestal

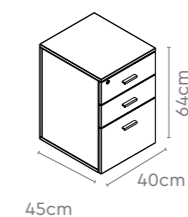

Pair with

Beat High Back Chair

→ Pg 96



All sizes in cm	Width	Depth	Height
T-22 Unitized Table	150.0	60.0	75.0
	150.0	75.0	75.0
	180.0	75.0	75.0
Wooden Pedestal	40.0	45.0	64.0

T-25 Unitized Table

Features

- The T-25 Unitized table has a clean and minimalistic aesthetic.
- Comes with an integrated switch box for power access, and a soft-closing access flap for easy cable management.
- Finished with an integrated storage unit with a drawer & HDU combination, and a modesty panel at the visitor's end.
- Available in multiple sizes and module configurations.



Design Registered

Colour & Material

METAL POWDER COAT

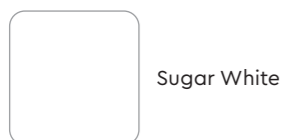

METAL EDGE BAND & POWDER COAT



Measurements

T-25 Unitized Table

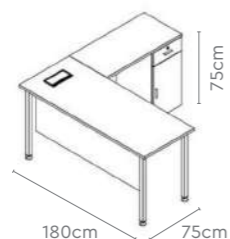

Pair with

Beat High Back Chair

→ Pg 96



All sizes in cm	Width	Depth	Height
T-25 Unitized Table	150.0	60.0	75.0
	150.0	75.0	75.0
	180.0	75.0	75.0

Enterprise

Features

- The Enterprise office desk has copious storage housed within a compact design.
- Available in a variety of sizes, with the 150 and 165 cm width variants featuring a wooden modesty panel for privacy.
- Wire slots are provided in the top frame for efficient wire management. And a vertical and horizontal wire carrier ensures a clutter-free and organised desk space.
- You can accessorise the Enterprise table with a CPU mount, to free up any floor space eaten up by the CPU.



Design Registered

Colour & Material

LAMINATE & POWDER COAT

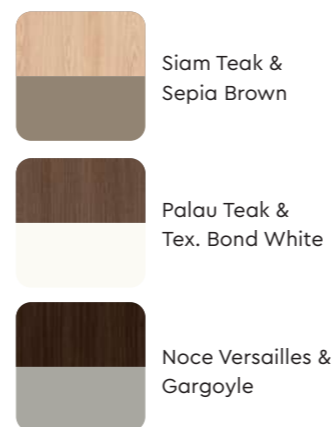

Measurements

LH Table



RH Table

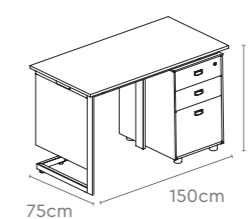

Pedestal



All sizes in cm	Width	Depth	Height
Executive Desk (LH/RH unit)	120.0	60.0	72.8
	135.0	75.0	72.8
	150.0	75.0	72.8
	165.0	90.0	72.8

Work



Features

- The Work desk puts in the work to ensure nothing interrupts yours.
- This all-wooden desk comes equipped with a free-standing 3-drawer pedestal for storing files, papers, and personal belongings.
- You can also accessorise it with a CPU trolley and a keyboard pull-out tray.
- Comes with wire management cut-outs on both the side panels for a clutter-free desktop.

Measurements

Work Desk 2

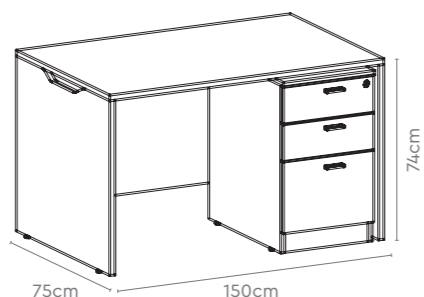

Colour & Material

LAMINATE



All sizes in cm	Width	Depth	Height
Work Desk 1	120.0	60.0	74.0
Work Desk 2	150.0	75.0	74.0

Aristo



Features

- The Aristo comes complete with softened corners and chamfered edges that offer user comfort and convenience.
- Its simple horizontal line pattern and dark wood grains make for an elegant finish.
- The soft-close sliding doors, with aluminium handles for back units, ensure ease of operation.

Measurements

Main Table 1

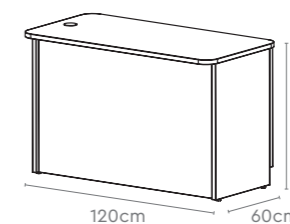

Main Table 2

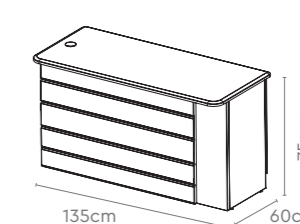

Colour & Material

MEMBRANE & LAMINATE

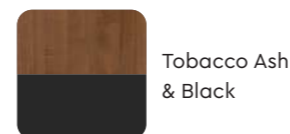

LAMINATE

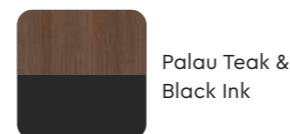

All sizes in cm	Width	Depth	Height
Main Table 1	120.0	60.0	75.0
Main Table 2	135.0	60.0	75.0



Design Registered

Topaz



Features

- The clean lines on the Topaz desk surface blend well with its raw wood grain and aesthetic door handles.
- Geometric lines run throughout the panel, making optimum use of lighter shades to present a uniform and neat look.
- The unique pattern on the fascia and the modesty panel, ups the style quotient of any space the Topaz sits in.

Measurements

Main Table 1

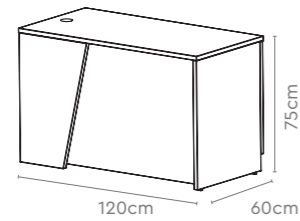

Main Table 2

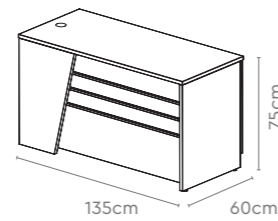

Design Registered

Colour & Material

MEMBRANE & LAMINATE

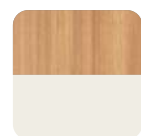

Tiepolo PC & Frosty White

All sizes in cm	Width	Depth	Height
Main Table 1	120.0	60.0	75.0
Main Table 2	135.0	60.0	75.0

Cignus



Features

- The swan-like flowing design of the Cignus desk is aesthetically highlighted with its contrasting colour scheme.
- All of its back units blend seamlessly with the main table, creating a rich and aesthetic office space.
- The flowing lines on the Cignus continue on its modesty, with a slanted cut to the panel that perfectly complements the return unit.

Measurements

Main Table 1

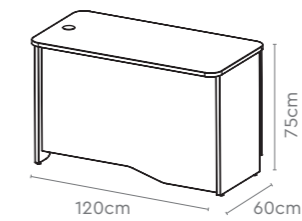

Main Table 2

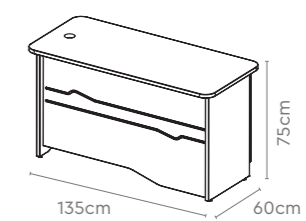

Design Registered

Colour & Material

MEMBRANE & LAMINATE



Noce Versailles & Frosty White

All sizes in cm	Width	Depth	Height
Main Table 1	120.0	60.0	75.0
Main Table 2	135.0	60.0	75.0

Unitized Table



Features

- The Unitized table range comes in different sizes to meet varying needs.
- Select models feature a footrest for added comfort.
- Multiple drawer combinations available to meet your storage requirements.
- Available in both round and tubular understructure.

Measurements

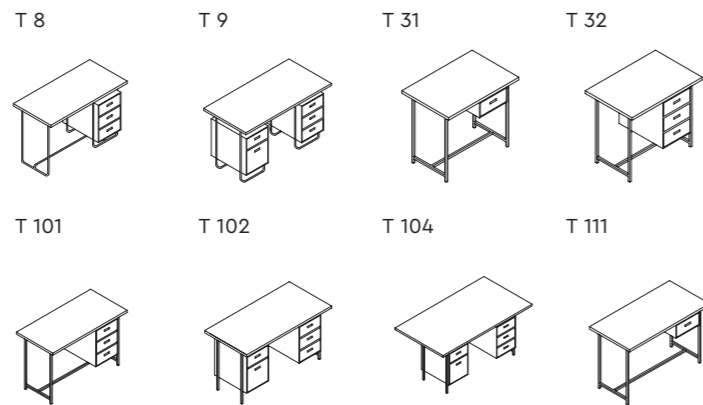

Colour & Material

LAMINATE & POWDER COAT

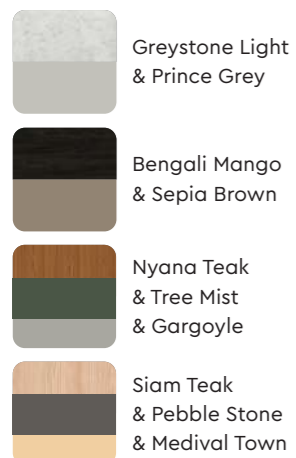

All sizes in cm	Width	Depth	Height
T 8	119.9	59.0	73.5
T 9	136.5	68.0	73.5
T 31	90.0	59.0	75.0
T 32	90.0	59.0	75.0
T 101	119.9	59.0	75.0
T 102	136.5	68.0	75.0
T 104	166.5	90.0	75.5
T 111	119.9	59.0	75.0

Unitized Table

Colour & Material

LAMINATE & POWDER COAT

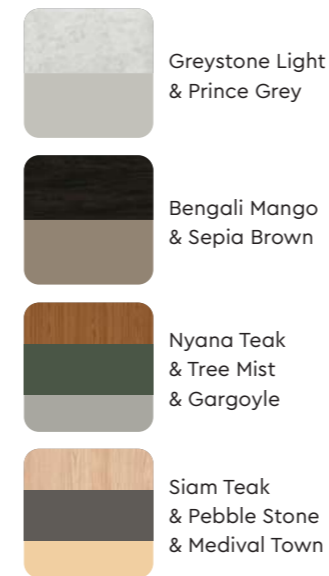

Measurements

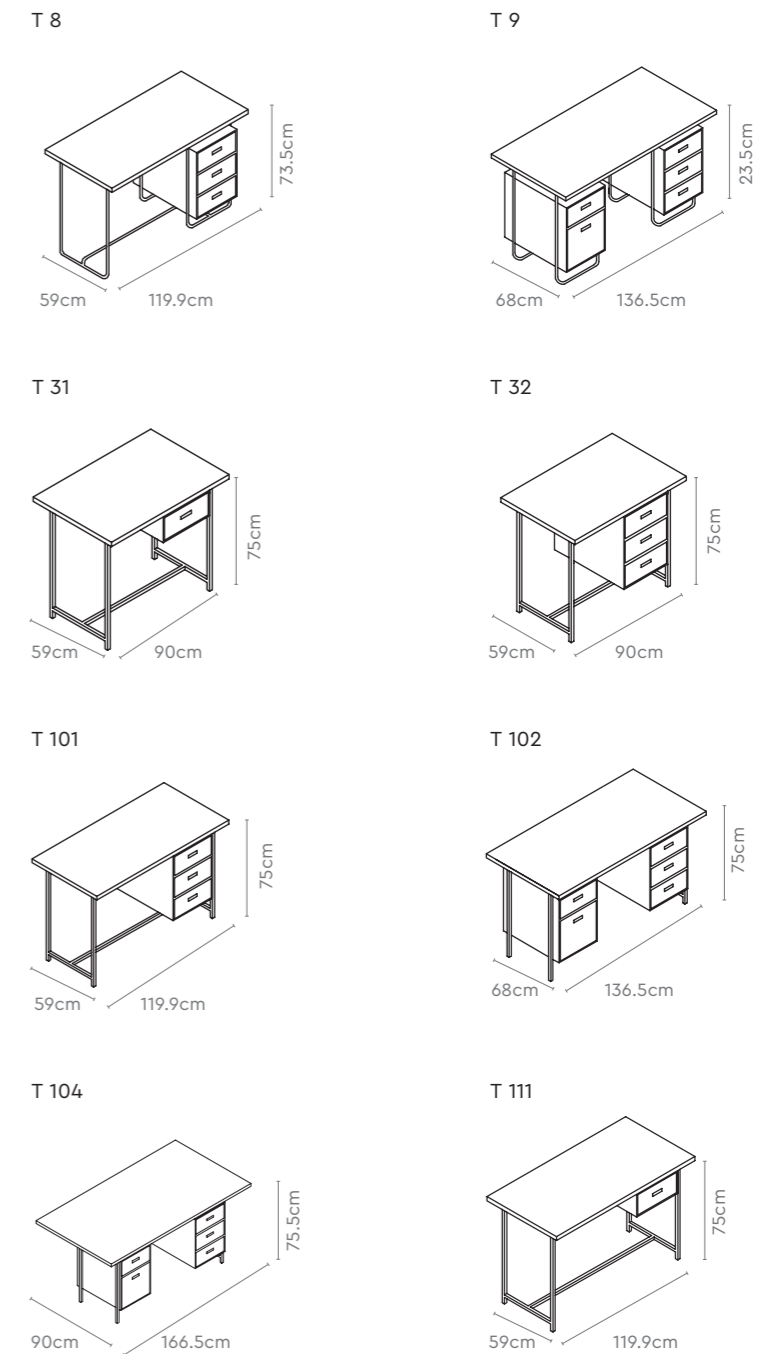

T-20 Unitized Table

Features

- The T-20 Unitized table has a clean and minimalistic aesthetic.
- Comes with an integrated switch box for power access, and a soft-closing access flap for easy cable management.
- Finished with a mobile wooden three drawer pedestal and a modesty panel at the visitor's end.
- Available in multiple sizes and module configurations.



Design Registered

Colour & Material

METAL POWDER COAT

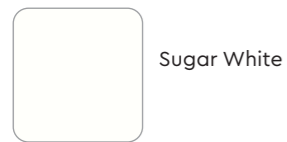

LAMINATE SHADE & POWDER COAT



Measurements

T-20 Unitized Table

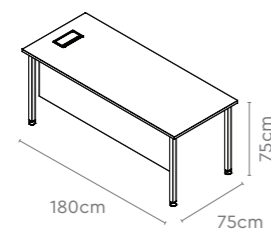

Wooden Pedestal

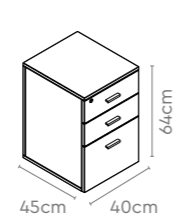

All sizes in cm	Width	Depth	Height
T-20 Unitized Table	180.0	75.0	75.0
	150.0	75.0	75.0
	150.0	60.0	75.0
	135.0	75.0	75.0
	120.0	60.0	75.0
Wooden Pedestal	40.0	45.0	64.0

Trident Junior



Features

- The Trident Junior is a trendy and compact all-wooden desk.
- Recommended for those who are looking for a compact option that aids productivity, while being easy to use.
- Comes with an in-built lockable drawer underneath the desktop, and an integrated 1-hinge door pedestal for storage.

Measurements

Trident Junior 2

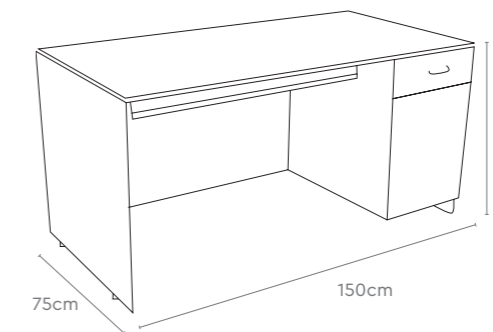

Colour & Material

LAMINATE

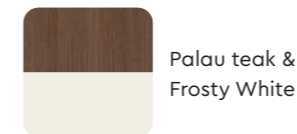

All sizes in cm	Width	Depth	Height
Trident Junior 1	120.0	60.0	74.3
Trident Junior 2	150.0	75.0	74.3

Stylo



Features

- Style, meet convenience.
- The Stylo table comes in 2 colours, with all-wood construction that lends itself to its aesthetic appeal.
- Ample storage space provided with 2 boxes and 1 file drawer, complete with a space for a CPU and a pull-out keyboard tray.

Measurements

Stylo

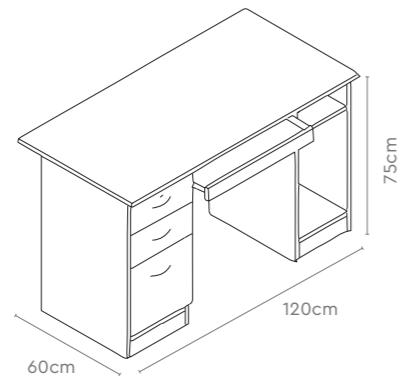

Colour & Material

LAMINATE



Noce Versailles



Siam Teak

All sizes in cm	Width	Depth	Height
Stylo	120.0	60.0	75.0

Enzo



Features

- The Enzo table is a compact all-wooden table that's aesthetic and functional.
- Can be customised with variable drawer combos to meet your specific needs.
- The drawers are lockable to ensure safe storage of all your valuables.

Measurements

Enzo - Variant 1

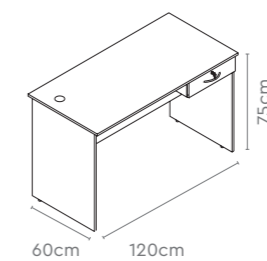

Enzo - Variant 2

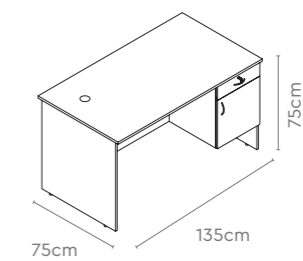

Enzo - Variant 3

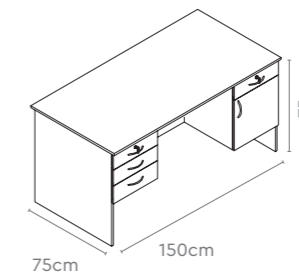

Colour & Material

WOOD



Bavarian Beech

All sizes in cm	Width	Depth	Height
Enzo	120.0	60.0	75.0
	135.0	75.0	75.0
	150.0	75.0	75.0

Modular

Mingle Concept



Features

- The Mingle is a modular conference table that can be configured to accommodate as many seats as you want it to.
- Each module is designed to provide ample leg space for comfortable meetings.
- The provision of a power module under the worktop keeps your desk clutter-free, and the cable holders allow for easy access while keeping your cables tangle-free.
- Grooves dotting the worktop enhances its look, while doubling up as pen holders.
- Available in PLT and MEM options.

In the set

Straight (Main/Shared/End of LH & RH)



Straight (Shared)



Corner Module

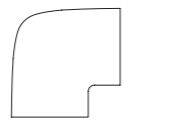

V1 Corner

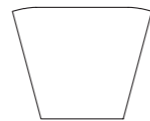

V2 Corner

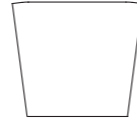

V1 Head Module (1459mm)

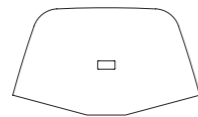

V2 Head Module (1509mm)

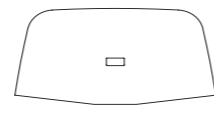

H1 Head Module (1800mm)

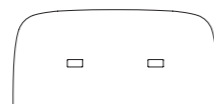

H2 Head Module (2350mm)



Colour & Material

PLT RANGE



Siam Teak/
White



Palau Teak/
Black

MEMBRANE RANGE



Amati PC/
Black

Modular

Closed Layout

H1 Head Module



H2 Head Module



Corner Module

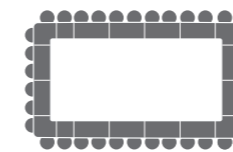

V1 and V2 Head Module



Measurements

Straight (Main/Shared/End of LH & RH)

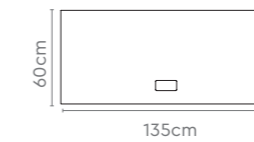

H1 Head Module (1800mm)

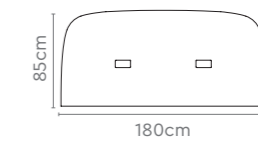

Straight (Main/Shared/End of LH & RH)

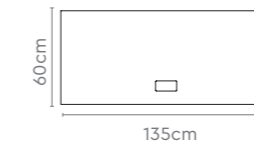

H2 Head Module (2350mm)

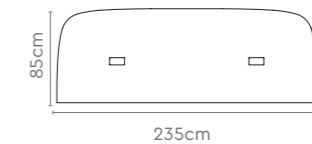

Straight (Shared)

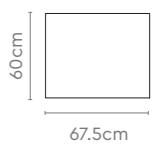

Straight (Main/Shared/End of LH & RH)

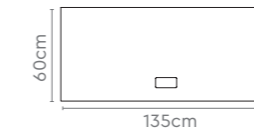

Corner Module



Straight (Main/Shared/End of LH & RH)



Corner Module

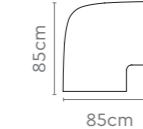

Straight (Shared)

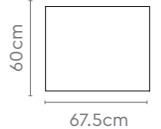

Straight (Main/Shared/End of LH & RH)

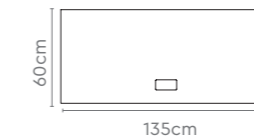

V1 Head Module (1459mm)

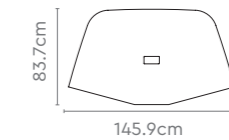

V1 Corner

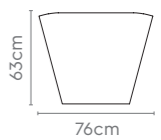

or

V2 Head Module (1509mm)

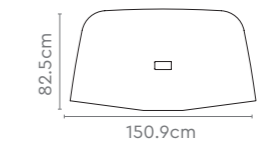

V2 Corner

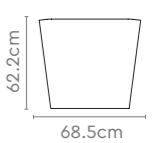

Modular

Open Layout

H1 Head Module

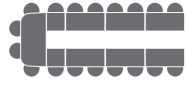

H2 Head Module



Corner Module

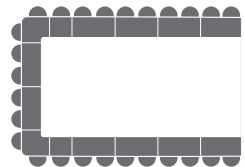

V1 and V2 Head Module

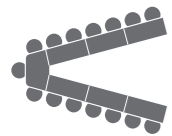

Measurements

Straight
(Main/Shared/End of LH & RH)

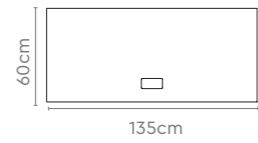

H1 Head Module
(1800mm)

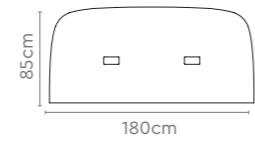

Straight
(Shared)

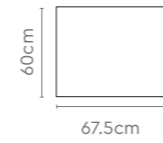

Straight
(Main/Shared/End of LH & RH)

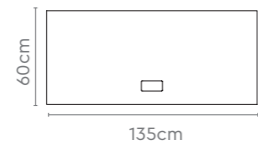

H2 Head Module
(2360mm)

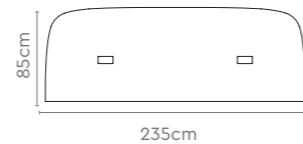

Straight
(Main/Shared/End of LH & RH)

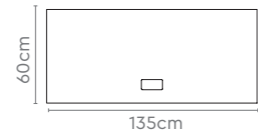

Corner Module

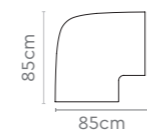

Straight
(Main/Shared/End of LH & RH)



Corner Module

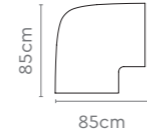

Straight
(Shared)

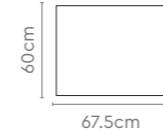

Straight
(Main/Shared/End of LH & RH)

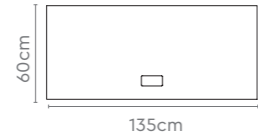

V1 Head Module
(1459mm)

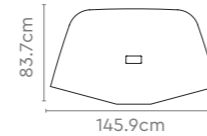

V1 Corner

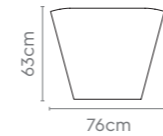

or

V2 Head Module
(1509mm)

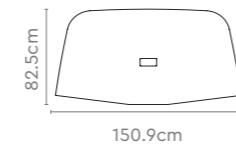

V2 Corner

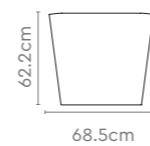

Elegance AV

Mingle Concept



Features

- The Mingle is a modular conference table that can be configured to accommodate as many seats as you want it to.
- Its cantilever module design provides ample leg space for comfortable meetings.
- Comes with a full length soft-closing wooden access flap for easy power and data access. The provision of a power module under the worktop keeps your desk clutter-free, and contains integrated cable cubby and retractor provision.
- Available in PLT and MEM options.

In the set

Straight
(Main/Shared/End of LH & RH)

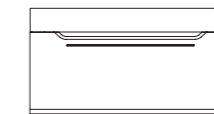

Straight
(Shared)

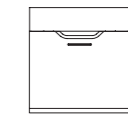

Corner Module

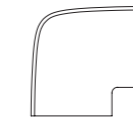

V1 Corner



V2 Corner



V1 Head Module

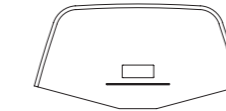

V2 Head Module

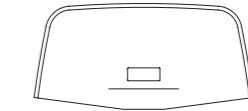

Colour & Material



Tobacco Ash & Orchidea Nera Supermatt

H1 Head Module
(1800mm)

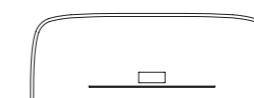

H2 Head Module
(2360mm)

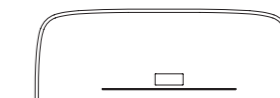

Pair with

Beat High Back Chair



→ Pg 96

Elegance AV

Closed Layout

H1 Head Module



Measurements

Straight
(Main/Shared/End of LH & RH)

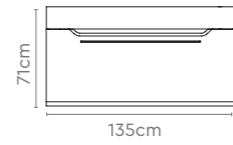

H1 Head Module
(1800mm)

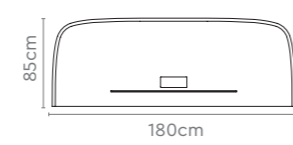

H2 Head Module



Straight
(Main/Shared/End of LH & RH)

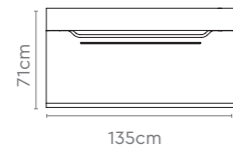

H2 Head Module
(2360mm)

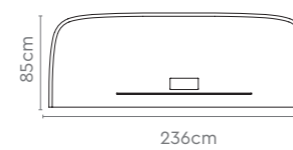

Straight
(Shared)

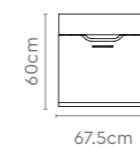

Corner Module

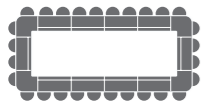

Straight
(Main/Shared/End of LH & RH)

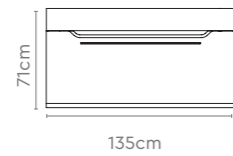

Corner Module

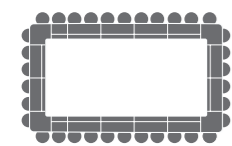
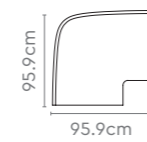

Straight
(Main/Shared/End of LH & RH)

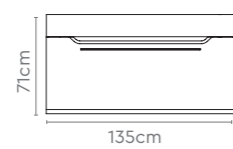

Corner Module

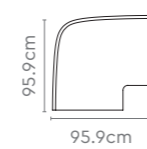

Straight
(Shared)

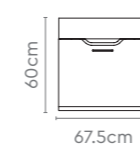

V1 and V2 Head Module



Straight
(Main/Shared/End of LH & RH)

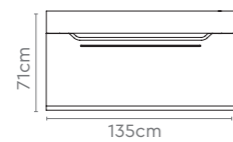

V1 Head Module
(1670mm)

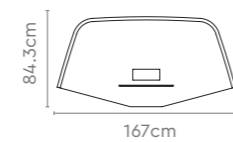

V1 Corner

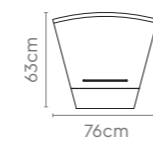

or

V2 Head Module
(1509mm)

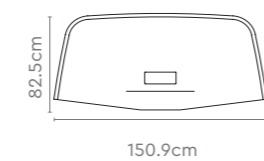

V2 Corner

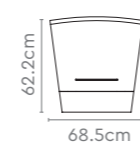

Elegance AV

Open Layout

H1 Head Module



Measurements

Straight
(Main/Shared/End of LH & RH)

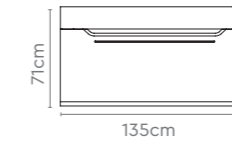

H1 Head Module
(1800mm)

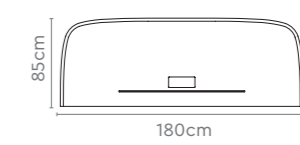

Straight
(Shared)

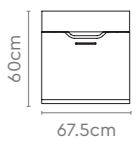

H2 Head Module



Straight
(Main/Shared/End of LH & RH)

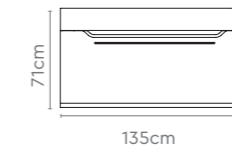

H2 Head Module
(2360mm)

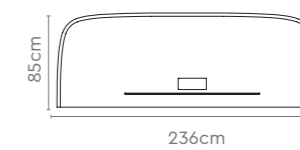

Corner Module

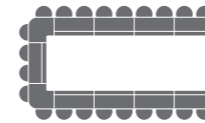

Straight
(Main/Shared/End of LH & RH)

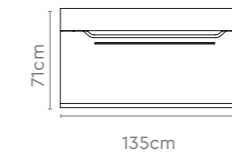

Corner Module

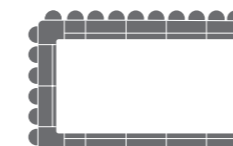
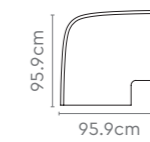

Straight
(Main/Shared/End of LH & RH)

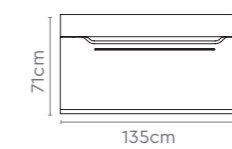

Corner Module

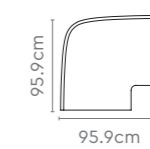

Straight
(Shared)

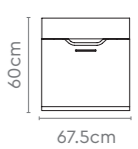

V1 and V2 Head Module

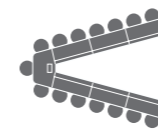

Straight
(Main/Shared/End of LH & RH)

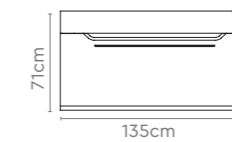

V1 Head Module
(1670mm)

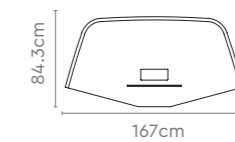

V1 Corner

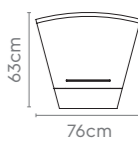

or

V2 Head Module
(1509mm)

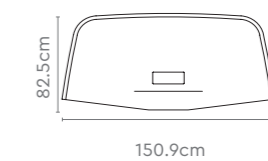

V2 Corner



Unitized

Mingle Concept



Features

- The Mingle – Unitized comes equipped with a soft-closing wooden access flap for easy power and data connectivity.
- The provision of a concealed wire management system under the worktop keeps your desk clutter-free.
- The worktop's shape has been designed specifically to provide optimum screen-view angle, with the AV range containing integrated cable cubby and retractor provision.
- Available in PLT and MEM options. Unitized AV available in MEM option.

In the set

PLT & Membrane Range

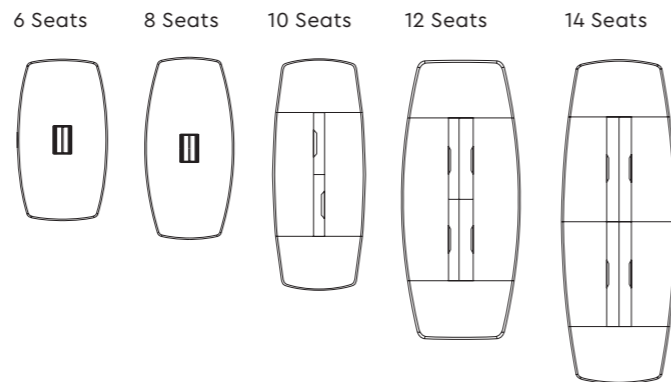

AV Range

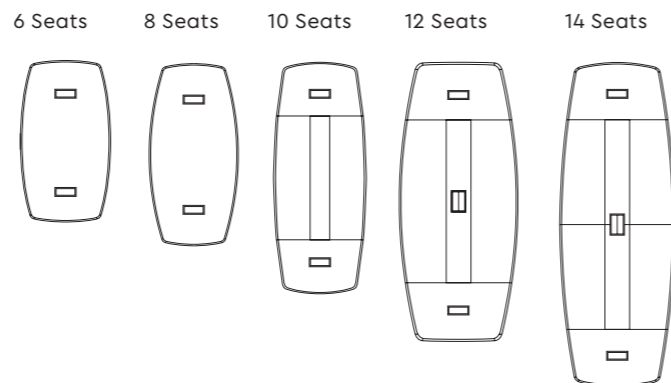

Colour & Material

PLT RANGE

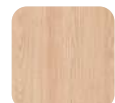

Siam Teak/
White



Palau Teak/
Black

MEMBRANE RANGE



Amati PC/
Black

Unitized

Colour & Material

PLT RANGE



Siam Teak/
White



Palau Teak/
Black

MEMBRANE RANGE



Amati PC/
Black

Measurements

PLT & Membrane Range

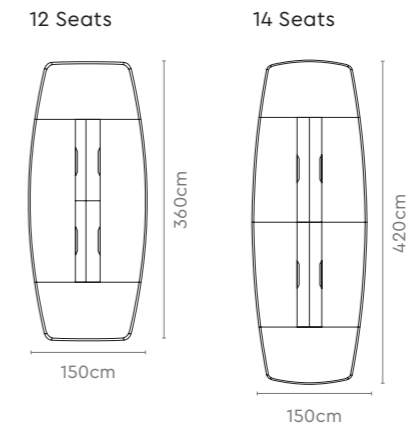
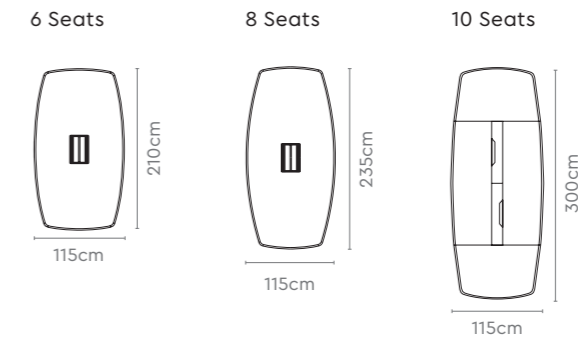

AV Range

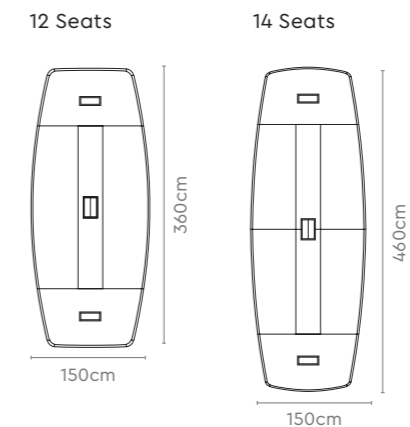
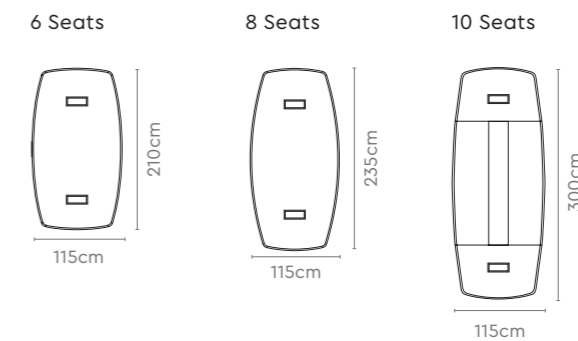

Gather

Mingle Concept



Features

- This conference table, boasting a contemporary design and aesthetics, is best suited for modern workspaces.
- It comes equipped with a central power module for easy power and data connectivity.
- Inject life into your workspace by pairing this table with the Gather range of accessories.
- Available in PLT and MEM options.

Measurements

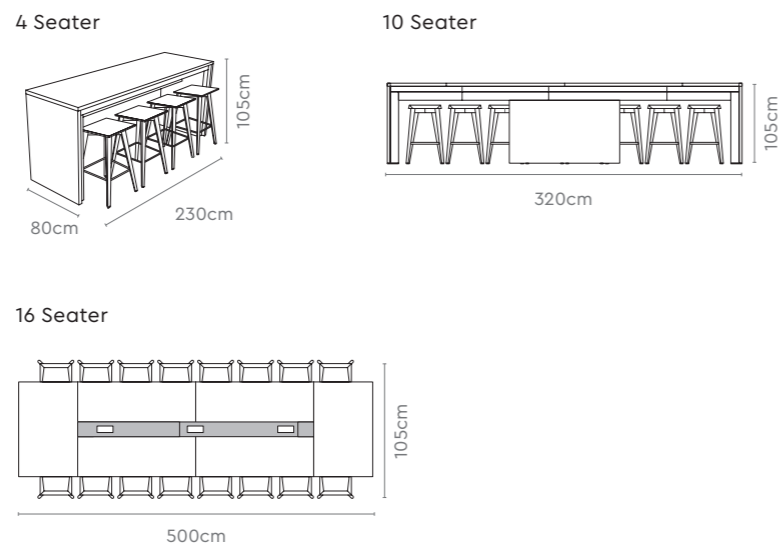

Colour & Material

PLT RANGE

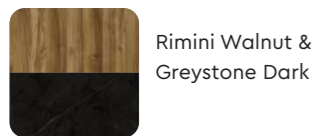

MEMBRANE RANGE

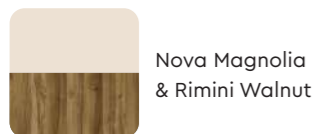

All sizes in cm	Width	Depth	Height
4 Seater	230.0	80.0	105.0
10 Seater	320.0	120.0	105.0
16 Seater	500.0	120.0	105.0

VC Collab

Mingle Concept

Features

- This AV-integrated conference table is equipped to take on the demands of the digital era.
- It comes in an aesthetically-pleasing design with a waterfall edge, and a worktop that offers optimal viewing experience to all its users.
- Eliminates the need for a special video conferencing room, and can also be used to nurture collaborative workspaces.
- Concealed channels provided to route wires and ensure a clutter and tangle-free workspace.



Colour & Material

MEMBRANE & LAMINATE

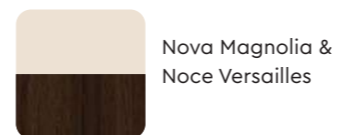

Measurements

Standard Seating

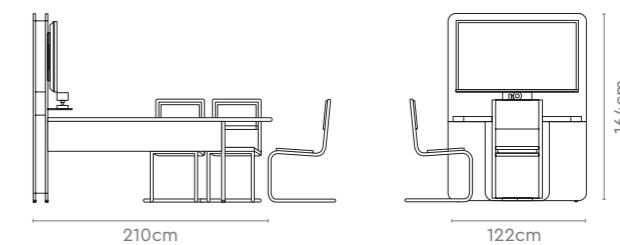

High Seating

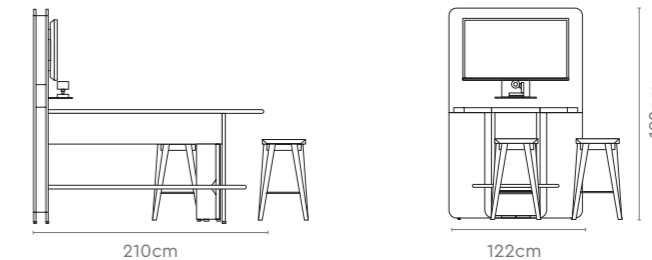

All sizes in cm	Width	Depth	Height
Standard Seating	210.0	122.0	164.0
High Seating	210.0	122.0	192.0

POD

Mingle Concept

Features

- The Mingle – Pod is equipped with an access flap for easy power and data connectivity.
- The provision of a concealed wire management system under the worktop keeps your desk clutter-free.
- It comes in an aesthetically-pleasing design, and a worktop that offers optimal viewing experience to all its users.
- Available in PLT and MEM options.



Colour & Material

PLT RANGE

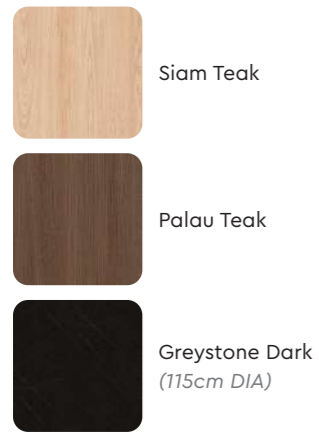

MEMBRANE RANGE

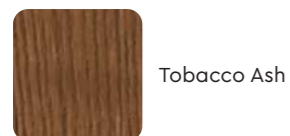

Measurements

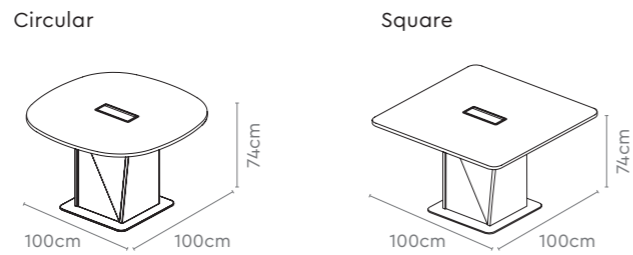

All sizes in cm	Width	Depth	Height	DIA
Circular	-	-	74.0	100.0
	-	-	74.0	115.0
Square	100.0	100.0	74.0	-
	115.0	115.0	74.0	-

Conclave



Design Registered

Features

- The Conclave conference table is sophistication redefined.
- This classy table is complete with a black-back painted glass top, made out of 12 mm thick toughened glass.
- Plug-and-play data and power points available for individual users, with an in-built concealed wire management system for a clean, neat, and clutter-free tabletop.
- Additional concealed storage available to keep supporting material at an arm's length during discussions.

Measurements

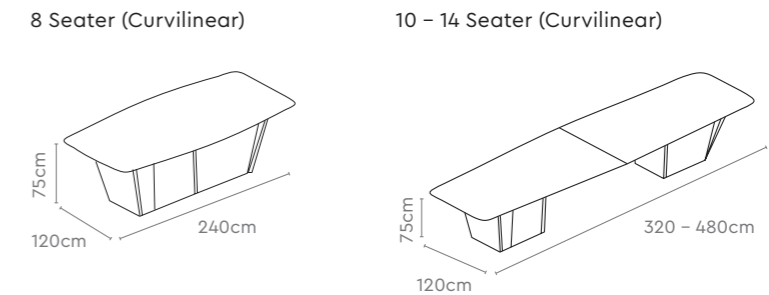

Colour & Material

LAMINATE

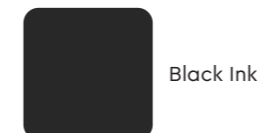

All sizes in cm	Width	Depth	Height
8 Seater Curve	240.0	120.0/ 150.0	75.0
10 Seater Curve	320.0	120.0/ 150.0	75.0
12 Seater Curve	400.0	120.0/ 150.0	75.0
14 Seater Curve	480.0	120.0/ 150.0	75.0

Reflection



Design Registered

Reflection

Features

- The Reflection reception table comes with a biophilic colour scheme that mirrors natural materials, making your office space feel more timeless and classy.
- The two levels of the table space enable seamless interaction with standing visitors, and with those with special needs.
- Dual-tone desk-front provides ample space to display your branding.
- Grommets included in the desks to tackle cables from landlines and printers.

Measurements

Linear 5 Feet



Linear 8 Feet



L-Shaped 8 Feet



Colour & Material

PLT RANGE

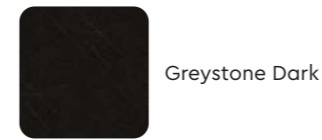

LAMINATE

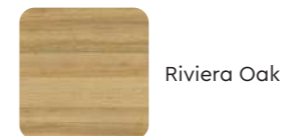

All sizes in cm

	Width	Depth	Height
Linear 5 Feet	150.0	87.0	108.0
Linear 8 Feet	240.0	87.0	108.0
L-Shaped 8 Feet	240.0	177.0/ 87.0	108.0

Flip Nxt

Features

- As the name suggests, the Flip NXT tables can be flipped up to make more room as and when needed.
- Its 360-degree rotating castors and an easy-to-access handle help flip the table up and down in a smooth manner.
- Comes in a sleek, compact, and lightweight design with rounded corners to avoid injury.
- Thanks to its unique leg design and understructure, the Flips NXT table blends well with most office spaces and aesthetics.



Colour & Material

MEMBRANE RANGE

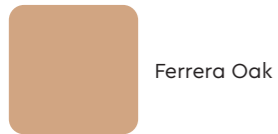

PU RANGE



Measurements



Fold Up Condition

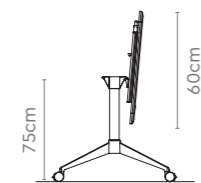

Stacked Condition

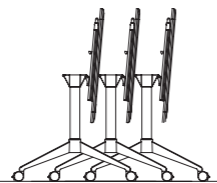

All sizes in cm	Width	Depth	Height
2 Seater	120.0	60.0	75.0
	135.0	60.0	75.0
4 Seater	150.0	75.0	75.0
	165.0	75.0	75.0
6 Seater	180.0	75.0	75.0

Cafe Pod

Features

- Clean design that accentuates any cafeteria space it's in.
- Can be folded when not in use, and stacked horizontally.
- Comes with a serrated stainless steel pedestal for increased sturdiness and superior aesthetics.



Colour & Material

PU RANGE



RUBBER WOOD

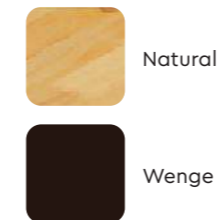

STAINLESS



Measurements

Rubber Wood Top



Stainless Stool Top



PU Top



Folded Condition



All sizes in cm	Width	Depth	Height
Rubber Wood Top	80.0	80.0	73.8
Stainless Stool Top	80.0	80.0	74.25
PU Top	80.0	80.0	74.5

Time Out

Features

- Add a pop of colour to your dining spaces with Godrej Interio's contemporary and stylish Time Out series of cafeteria tables.
- Table surfaces and understructure are easy to clean, maintain, and are designed to look fresh for years.
- Stackable, which helps you manage your space better.
- Available in PU-coated top (with powder-coated understructure) and membrane top (with stainless steel understructure).
- Comes in 4, 6, and 8 seater configurations.



Design Registered

Colour & Material

PU RANGE



MEMBRANE RANGE

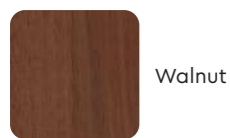

Measurements

4 Seater



6 Seater



8 Seater



All sizes in cm	Width	Depth	Height
4 Seater	102.2	102.2	75.0
6 Seater	162.2	102.2	75.0
8 Seater	222.2	102.2	75.0

Upbeat Café Tables



Features

- This High Table from the Upbeat Range has been designed to provide a richer work experience in modern offices.
- Comes in two types of legs and table-top options, providing versatility and style to any cafeteria space it's in.
- The seamless worktop comes in compact and both sides laminates.
- Finished with cross members for additional stability.

Measurements

Upbeat Café Table with Swing Leg



Pair with

Dfine Plus Leg



All sizes in cm	Width	Depth	Height
Upbeat Café Table - With Swing Leg (CL Top or PLB Top)	120.0/ 240.0	90.0	75.0
Upbeat Café Table - With Dfine Plus Leg (CL Top or PLB Top)	120.0/ 240.0	90.0	75.0

Relish

Features

- This sleek table comes in a wide range of colours that are suitable for both traditional and trendy food courts or meal spaces.
- It is easily stackable and helps with better space management.
- Relish is available in 4, 6 and 8-seater configurations, giving ample options to utilise the space.
- It is also available in PU-coated top & Membrane top.



Colour & Material

STAINLESS STEEL

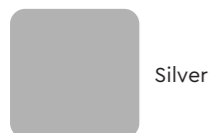

Silver

Measurements

Relish 1

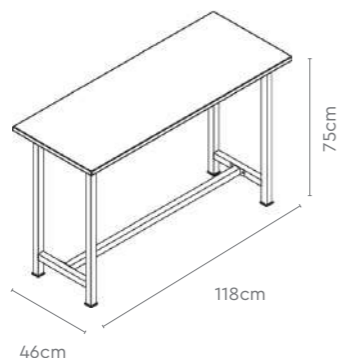

All sizes in cm	Width	Depth	Height
Relish 1	118.0	46.0	75.0
Relish 2	118.0	75.0	75.0

Cantina

Features

- The Cantina Table is thoughtfully designed to occupy minimal floor space.
- It frees up aisle space to facilitate easy movement.
- Comes with wide plastic shell seats that provide comfortable seating space for four.
- The Stainless Steel surface top with its brushed finish is resistant to scratches and easy to maintain.
- Level adjusters at the foot tackle uneven surfaces, adding to its overall stability.
- Its understructure is made up of 1.2mm thick powder-coated metal tubes welded to the stainless steel top.



Colour & Material

STAINLESS STEEL

TOP & STOOL

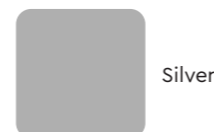

Silver

PLASTIC

CHAIR

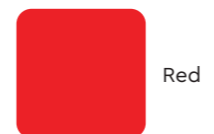

Red

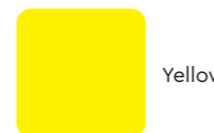

Yellow

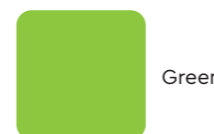

Green

Measurements

Cantina with Plastic Shell Seat

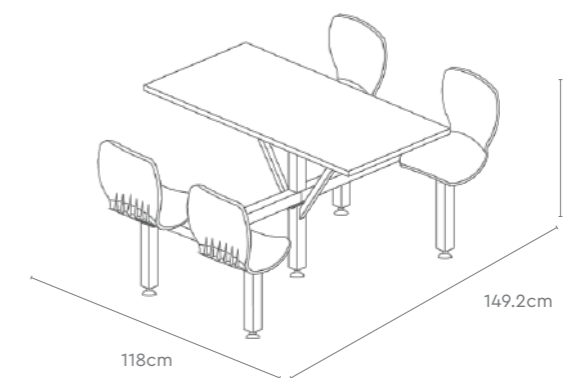

All sizes in cm	Width	Depth	Height
Cantina with Plastic Shell Seat	118.0	149.2	75.0
Cantina with Stainless Steel Stool	118.0	158.0	75.0

SPECTRUM

THE COLOUR EXPERIENCE

Colours, Materials, Finishes and Textures

Godrej Interio's Colour System — Spectrum — presents infinite possibilities for creating fresh and inspiring themes for workplaces. In the following pages, we demonstrate some of these possibilities using a curation of workplace themes, and a glimpse of the 100+ colours, materials, finishes and textures we offer.

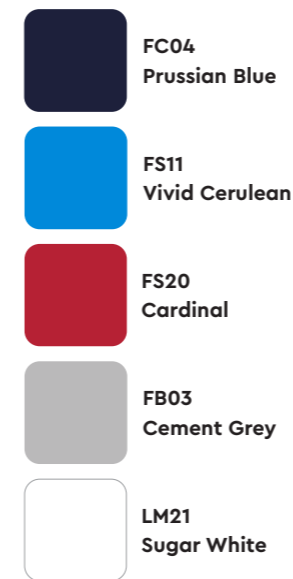

Inspired by Culture

A city rich in history, Jodhpur's architecture, colours and people signify a beautiful blend of traditions and warmth. Even as the city is adapting to urbanization, it communicates to stay rooted while exploring the new.

Inspired by Flavour

Spices define the nature of food, their intensity and combinations can enhance the punch in the flavour. A combination of such colours and materials triggers the required spark for an interesting conversation.





- FO69 Luminous
- PW34 Texas Yellow
- FB03 Cement Grey
- FO24 Blue Iceberg
- LM21 Sugar White

Inspired by Spry

Playing sports is not only a wonderful way to stay fit but it is also one of the best stress busters. Aspects of a game such as energy, team spirit and problem solving are synonymous to today's workforce.



- PW16 Sunset Sky
- PW11 Vivid Cerulean
- PW27 Sugar White
- MB114 Verade Oak Soft Natural

Inspired by Summer

A little bit of summer vacation is what might be the best time of the year; a sense of serene space may be with friends, sun, sand and sea is a longing state of mind.

Inspired by Refresh

Urban spaces have made us detached from nature. A refreshing, exhilarating experience of space with greens is a welcome break.

- FO14 Vitamin Bright
- FO33 Tree Mist
- PW27 Tex Bond White
- LM44 Warm Grey
- MB116 Amati PC







Inspired by Zest

Food is a dominant part of one's culture that helps strengthen the community at a workspace, and chilies are the most common ingredients that can bind multi-cultural cuisines together.



- FL06 Garnet
- PW27 Tex Bond White
- PW14 Gargoyle
- FK01 Black Ink
- LM104 Kitami Elm



-  FL04
Prussian Blue
-  LT52
Dark Tan
-  FL01
Black Ink
-  MB112
Tobacco Ash

Inspired by Regal

A meet that could shape the future needs the right setting and tone. An earthy and contemporary palette brings a feeling of power and authority.







Inspired by Active

Health is the highest priority for a new age worker. Healthy living is a growing focus area that urges us to practice an active lifestyle even at work. It makes us feel positive, energetic and motivated.

-  FS05
Leaf Green
-  FC02
Dark Tangerine
-  FS20
Cardinal
-  PW11
Vivid Cerulean
-  LM21
Sugar White



Foam Laminated Fabric Seating (FL)

-  FL01
Black Ink
-  FL04
Prussian Blue
-  FL06
Garnet
-  FL07
Royal Blue
-  FL08
Saddle Brown
-  FL10
Earth Stone
-  FL14
Vitamin Bright
-  FL56
Amethyst Regale

Breakout Fabric Seating (FB)

-  FB03
Cement Grey
-  FB04
Ink
-  FB18
Milan Red
-  FB51
Shadow

Sofa Fabric Seating (FS)

-  FS02
Dark Tangerine
-  FS04
Denim
-  FS05
Leaf Green
-  FS11
Vivid Cerulean
-  FS20
Cardinal
-  FS72
Mink
-  Peacock
-  Flame
-  Citron
-  Cement Grey

Crepe Fabric Seating (FC)

Voila



Knitted Fabric Seating (FK)

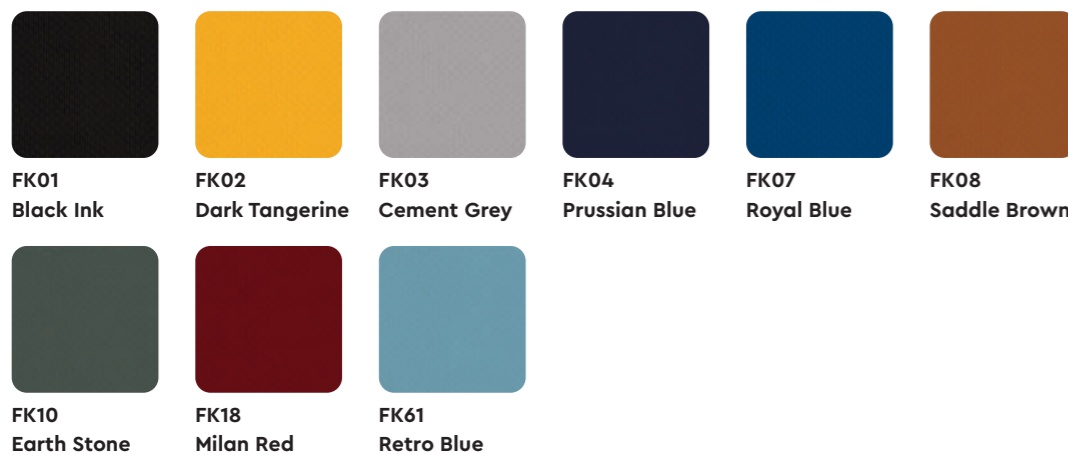

Leatherette Sofa (LS)



Leather (LT)



Leatherette Chair (LC)



Net / Micro Mesh / Spacer Fabric Seating (NM & SF)

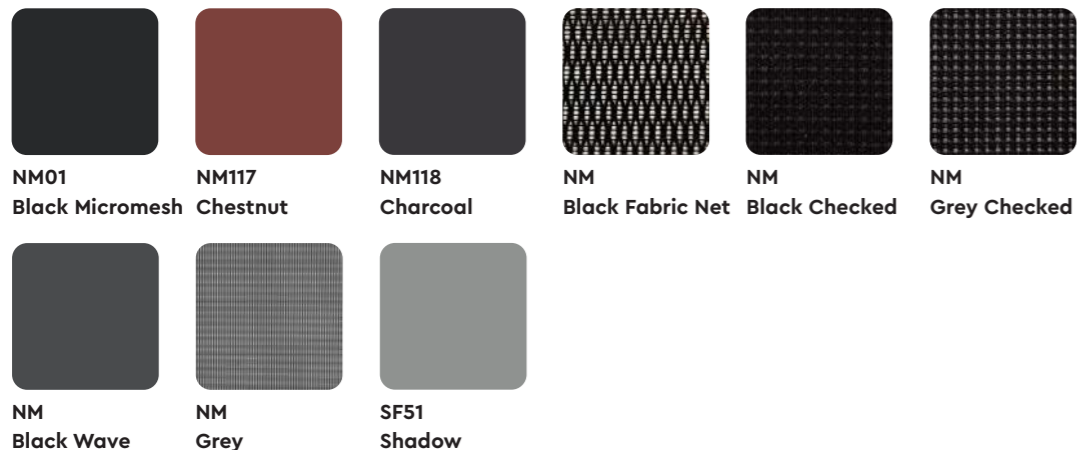

Plush Fabric (FP)



Unwind Range



Laminate (LM)

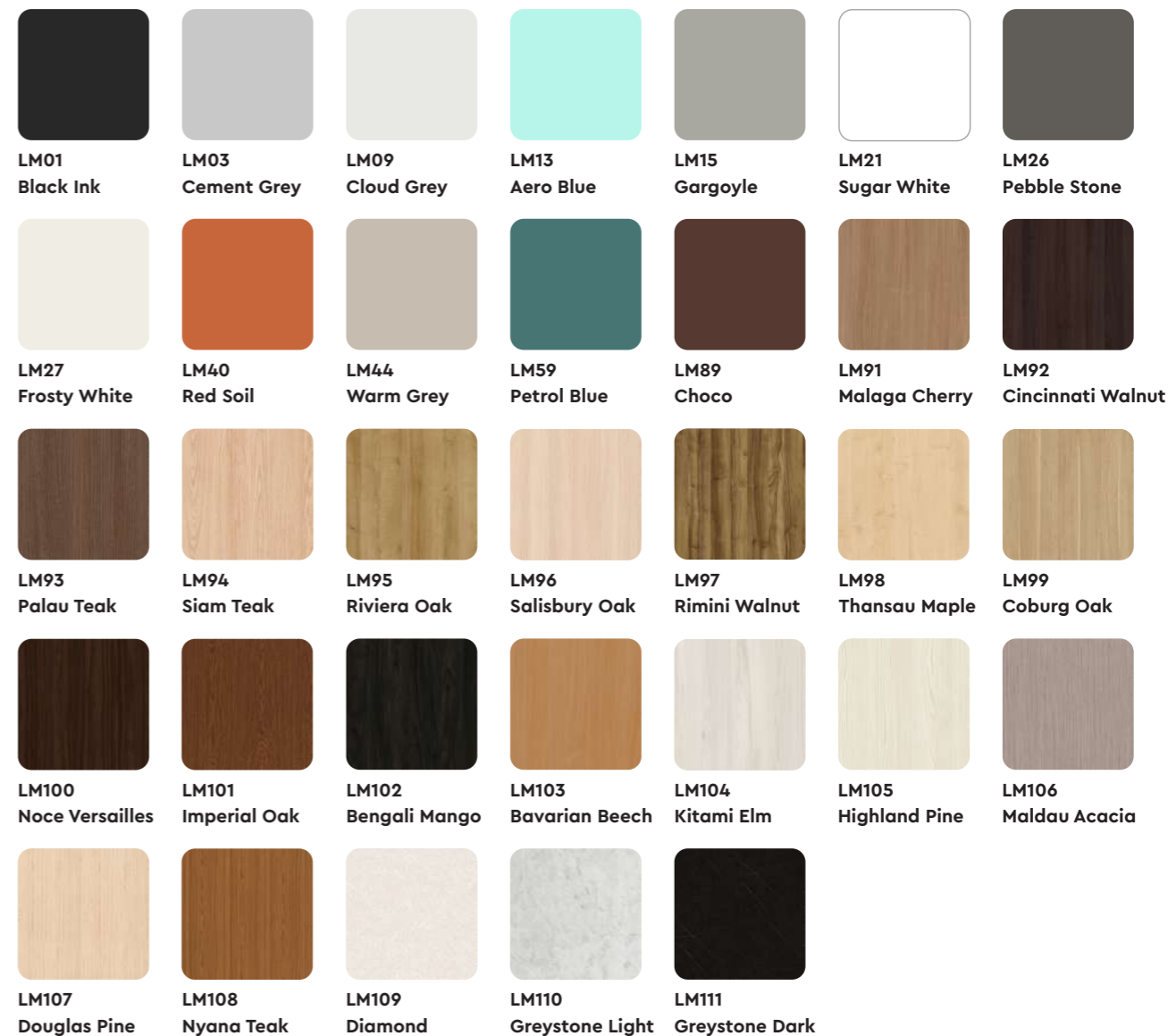

Membrane Range (MB)

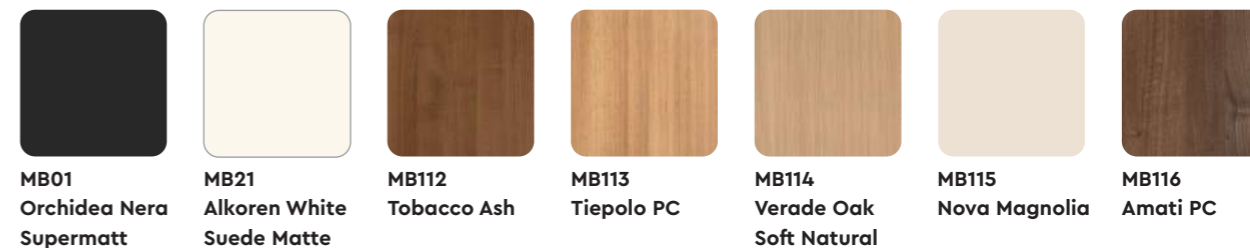

Fabric Modular (FO)

						
FO02 Dark Tangerine	FO03 Cement Grey	FO04 Prussian Blue	FO05 Leaf Green	FO06 Garnet	FO07 Royal Blue	FO08 Saddle Brown
						
FO10 Earth Stone	FO11 Vivid Cerulean	FO12 Azure	FO13 Aero Bue	FO14 Vitamin Bright	FO15 Gargoyle	FO16 Sunset Sky
						
FO19 Indian Red Chili	FO20 Cardinal	FO22 Orchid Purple	FO24 Blue Iceberg	FO25 Country Green	FO28 Boysenberry	FO29 Amethyst
						
FO30 Powder Blue	FO31 Blue Grass	FO33 Tree Mist	FO35 Victorian Gold	FO36 Cream	FO38 Oranger Spark	FO39 Burnt Orange
						
FO41 Young Wine	FO42 Copper Moon	FO44 Warm Grey	FO45 Stone Path	FO46 Roasted Bean	FO47 Champagne	FO54 Fresh Leaf
						
FO55 Plum Pastel	FO57 Baby Blue	FO58 Caspian Sea	FO60 Blue Ivy	FO62 Citrus	FO63 Green Sea	FO65 Conifer
						
FO67 Jungle Cane	FO69 Luminous	FO70 Fuscia	FO70 Jaipur Pink	FO73 White Sand	FO75 Acron	FO76 Indian Coffee
						
FO85 Granada	FO86 Latte	FO87 Sliver Line	FO88 Caramel			

Powder Coat (PW)

						
PW01 Black Ink	PW02 Dark Tangerine	PW03 Cement Grey	PW04 Prussian Blue	PW05 Leaf Green	PW06 Garnet	PW09 Cloud Grey
						
PW11 Vivid Cerulean	PW13 Aero Blue	PW14 Gargoyle	PW16 Sunset Sky	PW18 Indian Red Chili	PW20 Cardinal	PW21 Sugar White
						
PW24 Blue Iceberg	PW26 Pebble Stone	PW27 Tex Bond White	PW33 Tree Mist	PW34 Texas Yellow	PW40 Red Soil	PW41 Young Wine
						
PW44 Warm Grey	PW48 Slate Grey	PW54 Fresh Leaf	PW66 Lime	PW68 Banana Yellow	PW74 Horizon	PW78 Medieval Town
						
PW81 Sepia Brown	PW82 Prince Grey	PW83 Platinum Silver	Matt Taupe White			

Godrej interio HEALTHCARE

Visit our Healthcare Experience Centre to experience the latest healthcare products from our range, firsthand — from patient care, to medical screening to office & leisure furniture.

Products Available: ICU Beds, Examination Beds, Gynaec Examination Couch, Recovery Bed, Emergency Trolley, Nursing Station, Office Furniture and more.



Lab



Fusion



Nucleus



Aeolus

Godrej interio

Available in over 600 locations in India.

North: Delhi, Chandigarh, NCR, Lucknow
South: Chennai, Bengaluru, Hyderabad, Kochi
West: Mumbai, Ahmedabad, Bhopal, Pune
East: Kolkata, Bhubaneswar, Guwahati, Patna

Godrej & Boyce Mfg. Co. Ltd.

Godrej Interio,
Pirojshanagar, Vikhroli (W),
Mumbai 400 079

Toll Free Number: 1800-209-5511

Email: interiooffice@godrej.com

Fax: +91-22-6796 1503

Put some play into your work by visiting
godrejinterio.com/business

Follow us on /godrejinterio



Godrej interio

talk green.
walk green.

An initiative by Godrej Interio,
the first Indian furniture
company with GREENGUARD
certified products.



India's
Most Desired Brand
TRA Research
Furniture Category
July 2021



India's
Most Trusted Brand
TRA Research
Furniture Category
February 2022



**Franchise India
Retail Brand
of the Year**
Speciality/Furniture
Retail Category
December 2022



Marksmen Daily
Most Preferred Brand
2022

MODULAR FURNITURE . DESKING . SEATING . STORAGE . INTERIORS . LAB . HEALTHCARE . HOME



The GREENGUARD Certification Program gives assurance that products designed for use in indoor spaces meet strict chemical emission limits, which create healthier interiors. The certification qualifies for LEED credits and IGBC credits.

In keeping with the Godrej policy of continuous development and improvement, the design, dimension and specification may be updated without prior notice or obligations. Form, Colour and Finish of product in this document are representative of design intent and may vary from actual. Colour options depicted in this catalogue are as close to what modern printing processes allow. All dimensions are in 'cm' and are subject to commercial tolerance. Our products are meant for indoor use only.

B2BGOVTDOSI2023